

TECHNICAL MANUAL

ORGANIZATIONAL, DIRECT SUPORT, AND GENERAL SUPPORT MAINTENANCE

REPAIR PARTS AND SPECIAL TOOLS LISTS

(INCLUDING DEPOT MAINTENANCE REPAIR PARTS AND SPECIAL TOOLS)

FOR

TEST SET, STABILIZATION EQUIPMENT

TS-1894/ASM

(PART NO. 114E5987-4),

NSN 4920-00-959-6125)

(PART NO. 114E5987-8,

NSN 6615-00-133-7834)

HEADQUARTERS, DEPARTMENT OF THE ARMY

OCTOBER 1978

**ORGANIZATIONAL, DIRECT SUPPORT, AND GENERAL SUPPORT MAINTENANCE
 REPAIR PARTS AND SPECIAL TOOLS USTS
 (INCLUDING DEPOT MAINTENANCE REPAIR PARTS AND SPECIAL TOOLS)
 FOR
 TEST SET, STABILIZATION EQUIPMENT TS- 1894/ASM
 (Part No. 114E5987-4, NSN 4920-00-959-6125)
 (Part No. 114E5987-8, NSN 6615-00-133-7834)**

Current as of 21 June 1978

REPORTING OF ERRORS

You can improve this manual by recommending improvements using DA Form 2028-2 located in the back of the manual. Simply tear out the self-addressed form, fill it out as shown on the sample, fold it where shown, and drop it in the mail.

If there re no blank DA Forms 2028-2 in the back of your manual, use the standard DA Form 228 (Recommended Change to Publications and Blank Forms) and forward to the Commander, US Army Communications and Electronics Materiel Readiness Command, ATTN: DRSEL-ME-MQ, Fort Monmouth, NJ 07703.

In either case a reply will be furnished direct to you.

Table of Contents

	Page	Ilus Figure
SECTION I. INTRODUCTION.....	1	
II. REPAIR PARTS LIST	5	
GROUP 00 Test Set, Stabilization Equipment TS-1894/ASM.....	5	1
01 Case, test set 120HFS	7	2
02 Box assembly adapter 114V3058-1	9	8
0201 Cable assembly 114V8062-1	10	4
0202 Component assembly 114V060-1	11	5
08 Cable assembly A02VS809-2	12	6
04 Cable assembly A02VS309-3	13	7
05 Cable assembly A02VSS09-1	14	8
06 Panel assembly, front 114E5987-7	17	9
0601 Component assembly, actuator simulator card A02V3048-2.....	23	10
0602 Component assembly, amplifier card 114E3049-47-2.....	27	11
0603 Component assembly, card A02V3060-2	31	12
0604 Component assembly, card A02V8068-1	33	13
0606 Component assembly, card A02V3064-2	35	14
0606 Cable harness 114E5987-5.....	36	16
0607 Pump assembly, air 080P110-202	39	16
0608 Meters (M1, M2, M8, M4) (No parts authorized)		
0609 Gaga, air (No parts authorized)		
0610 Motor, pump (No parts authorized)		
SECTION III. SPECIAL TOOLS LIST	40	17
IV. NATIONAL STOCK NUMBER AND PART NUMBER INDEX	41	

*This manual supersedes TM 11 TM 11-6625-646-24P, 9 May 1977.

SECTION I

INTRODUCTION

1. Scope

This manual lists spares and repair parts; special tools; special test, measurement, and diagnostic equipment (TMDE), and other special support equipment required for performance of organizational, direct support, and general support maintenance of the TS-1894/ASM. It authorizes the requisitioning and issue of spares and repair parts as indicated by the source and maintenance codes.

2. General

This Repair Parts and Special Tools List is divided into the following sections:

a. Section II. Repair Parts List. A list of spares and repair parts authorized for use in the performance of maintenance. The list also includes parts which must be removed for replacement of the authorized parts. Parts lists are composed of functional groups in numeric sequence, with the parts in each group listed in figure and item number sequence.

b. Section III. Special Tools List. A list of special tools, special TMDE, and other special support equipment authorized for the performance of maintenance.

c. Section IV. National Stock Number and Part Number Index. A list, in National item identification number (NIIN) sequence, of all National stock numbers (NSN) appearing in the listings, followed by a list, in alphanumeric sequence, of all part numbers appearing in the listings. National stock numbers and part numbers are cross-referenced to each illustration figure and item number appearance.

3. Explanation of Columns

a. Illustration. This column is divided as follows:

(1) *Figure number.* Indicates the figure number of the illustration on which the item is shown.

(2) *Item number.* The number used to identify item called out in the illustration.

b. Source, Maintenance, and Recoverability (SMR) Codes.

(1) *Source code.* Source codes indicate the manner of acquiring support items for maintenance, repair, or overhaul of end items. Source codes are entered in the first and second positions of the Uniform SMR Code format as follows:

<i>Code</i>	<i>Definition</i>
PA -	Item procured and stocked for anticipated or known usage.
PE -	Support equipment procured and stocked for initial issue or outfitting to specified maintenance repair activities.
XD -	A support item that is not stocked. When required, item will be procured through normal supply channels.

NOTE

Cannibalization or salvage may be used as a source of supply for any items source coded above except those coded XA and aircraft support items as restricted by AR 700-42.

(2) *Maintenance code.* Maintenance codes are assigned to indicate the levels of maintenance authorized to USE and REPAIR support items. The maintenance codes are entered in the third and fourth positions of the Uniform SMR Code format as follows:

(a) The maintenance code entered in the third position will indicate the lowest maintenance level authorized to remove, replace, and use the support item. The maintenance code entered in the third position will indicate one of the following levels of maintenance:

<i>Code</i>	<i>Application/Explanation</i>
O -	Support item is removed, replaced, used at the organizational level.
H -	Support item is removed, replaced, used at the general support level.

(b) The maintenance code entered in the fourth position indicates whether the item is to be repaired and identifies the lowest maintenance level with the capability to perform complete repair (i.e., all authorized maintenance functions). This position will contain one of the following maintenance codes:

<i>Code</i>	<i>Application/Explanation</i>
H -	The lowest maintenance level capable of complete repair of the support item is the general support level.
Z -	Non-reparable. No repair is authorized.

(3) *Recoverability code.* Recoverability codes are assigned to support items to indicate the disposition action on unserviceable items. The recoverability code is entered in the fifth position of the Uniform SMR Code format as follows:

Recoverability codes

Definition

Z - Non-reparable item. When unserviceable, condemn and dispose at the level indicated in position 3.

H - Reparable item. When uneconomically reparable, condemn and dispose at the general support level.

c. *National Stock Number.* Indicates the National stock number assigned to the item and will be used for requisitioning purposes.

d. *Part Number.* Indicates the primary number used by the manufacturer (individual, company, firm, corporation, or Government activity), which controls the design and characteristics of the item by means of its engineering drawings, specifications, standards, and inspection requirements to identify an item or range of items.

NOTE

When a stock numbered item is requisitioned, the repair part received may have a different part number than the part being replaced.

e. *Federal Supply Code for Manufacturer (FSCM).* The FSCM is a 5-digit numeric code listed in SB 708-42 which is used to identify the manufacturer, distributor, or Government agency, etc.

f. *Description.* Indicates the Federal item name and, if required, a minimum description to identify the item. In the Special Tools List, the initial basis of issue (BOI) appears as the last line in the entry for each special tool, special TMDE, and other special support equipment. When density of equipment supported exceeds density spread indicated in the basis of issue, the total authorization is increased accordingly.

g. *Unit of Measure (U/M).* Indicates the standard of the basic quantity of the listed item as used in performing the actual maintenance function. This measure is expressed by a two-character alphabetical abbreviation (e.g., ea., in, pr, etc.). When the unit of measure differs from the unit of issue, the lowest unit of

issue that will satisfy the required units of measure will be requisitioned.

h. *Quantity Incorporated in Unit.* Indicates the quantity of the item used in the breakout shown on the illustration figure, which is prepared for a functional group, sub-functional group, or an assembly.

4. Special Information

The following publication pertains to the TS. 1894/ASM .and its components: TM 11-6625r646-15, Test Set, Stabilization Equipment TS-1894/ASM

5. How to Locate Repair Parts

a. When National stock number or part number is unknown.

(1) *First.* Using the table of contents, determine the functional group within which the item belongs. This is necessary since illustrations are prepared for functional groups and listings are divided into the same groups.

(2) *Second.* Find the illustration covering the functional group to which the item belongs.

(3) *Third.* Identify the item on the illustration and note the illustration figure and item number of the item.

(4) *Fourth.* Using the Repair Parts Listing, find the figure and item number noted on the illustration.

b. When National stock number or part number is known.

(1) *First.* Using the Index of National Stock Numbers and Part Numbers, find the pertinent National stock number or part number. This index is in NIIN sequence followed by a list of part numbers in alphanumeric sequence, cross-referenced to the illustration figure number and item number.

(2) *Second.* After finding the figure and item number, locate the figure and item number in the repair parts list.

6. Abbreviations

Not applicable.

(Next printed page is 4)

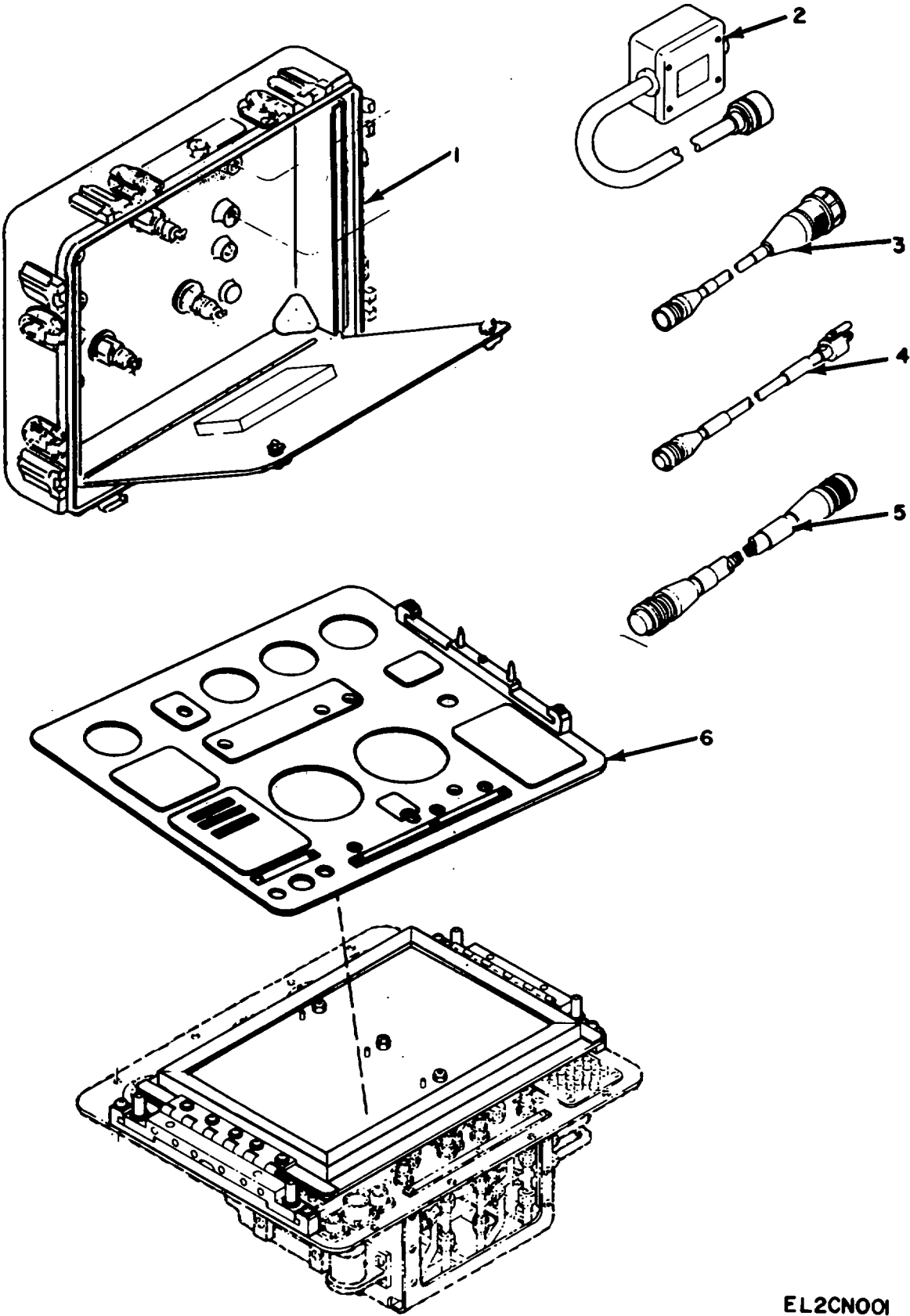

EL2CN001

Figure 1. Test Set, Stabilization Equipment TS-1894/ASM.

SECTION II

TM 11-6625-646-24P

(1) ILLUSTRATION		(2)	(3)	(4)	(5)	(6) DESCRIPTION	(7)	(8)
(a) FIG NO.	(b) ITEM NO.	SMR CODE	NATIONAL STOCK NUMBER	PART NUMBER	FSCM	USABLE ON CODE	U/M	QTY INC IN UNIT
						GROUP 00 TEST SET STABILIZATION EQUIPMENT TS-1894/ASM		
1	1	XDHHH		120H1FS	94637	CASE, TEST SET.....	EA	1
1	2	PAOHH	6615-00-133-7838	114V3058-1	77272	BOX ASSEMBLY, ADAPTER.....	EA	1
1	3	PAOHH	5995 00-909-1915	A02VS309-3	77272	CABLE ASSEMBLY.....	EA	1
1	4	PAOHH	5995-00-906-6403	A02VS309-2	77272	CABLE ASSEMBLY.....	EA	1
1	5	PAOHH	5995-00-909-1913	A02VS309-1	77272	CABLE ASSEMBLY.....	EA	1
1	6	XDHHH		114ES597-7	71272	PANEL ASSEMBLY, FRONT.....	EA	1
					5			

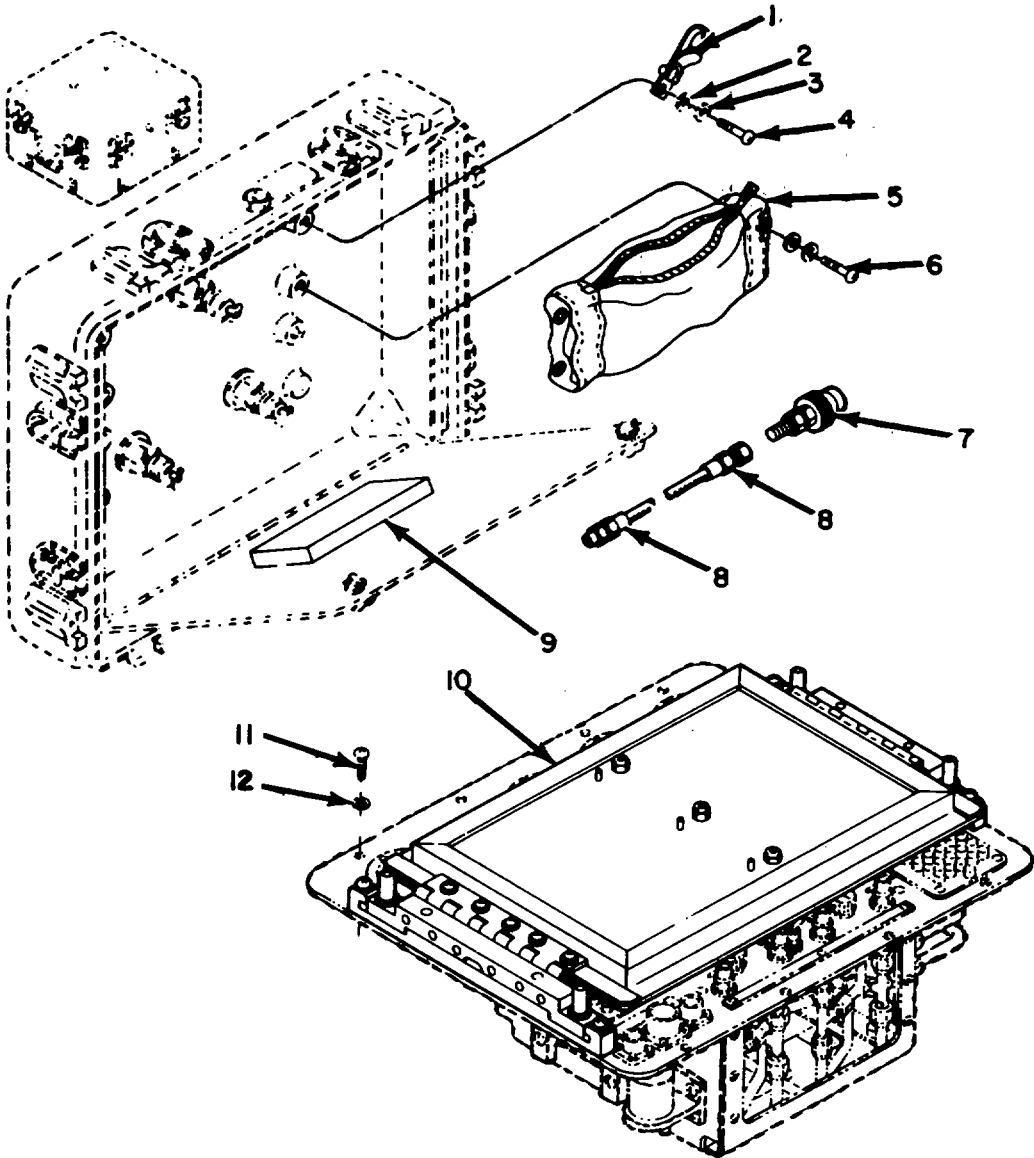

EL2CNO02

Figure 2. Case, Test Set 120HIFS.

SECTION II

TM 11-6625-646-24P

(1) ILLUSTRATION		(2)	(3)	(4)	(5)	(6) DESCRIPTION	(7)	(8)
(a) FIG NO.	(b) ITEM NO.	SMR CODE	NATIONAL STOCK NUMBER	PART NUMBER	FSCM	USABLE ON CODE	U/M	QTY INC IN UNIT
						GROUP 01 CASE, TEST SET 120HIFS		
2	1	XDHZZ		A7990-121-24A	18553	CLAMP, HARNESS	EA	4
2	2	XDHZZ	5310-00-167-0133	AN960-8L	88044	WASHER	EA	8
2	3	XDHZZ		MS35338-80	96906	WASHER	EA	8
2	4	XDHZZ		AN515-8R6	08044	SCREW	EA	4
2	5	PAHZZ	6625-00-918-1850	A02VS3101	77272	BAG ASSEMBLY	EA	1
2	6	XDHZZ		AN51508R6	88044	SCREW	EA	4
2	7	PAHZZ	4730-00-684-0738	1011-4	00624	COUPLING, QUICK DISCONNECT	EA	4
2	8	PAHZZ	4720-00-720-0294	AN62704D0420	88044	HOSE ASSEMBLY	EA	4
2	9	XDHZZ		114E5987-9	77272	BUMPER	EA	1
2	10	XDHZZ		A02V3044-25	77272	RETAINER ASSEMBLY	EA	1
2	11	XDHZZ		AN520-10R14	88044	SCREW	EA	8
2	12	XDHZZ	5310-00-167-0834	AN960-10L	88044	WASHER	EA	8
					7			

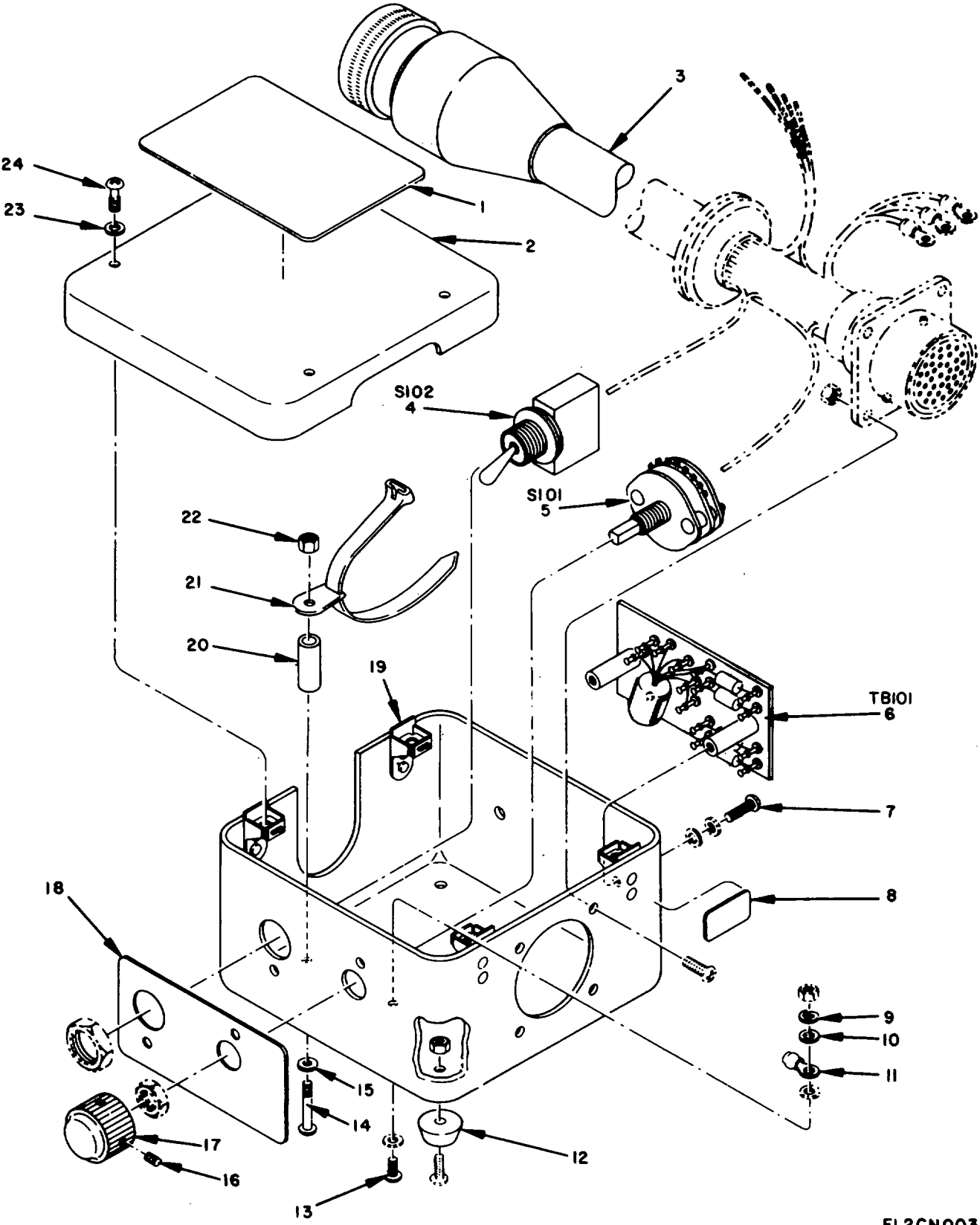

Figure 3. Box Assembly, Adapter 114V3058-1.

EL2CN003

SECTION II

TM 11-6625-646-24P

(1) ILLUSTRATION		(2)	(3)	(4)	(5)	(6) DESCRIPTION	(7)	(8)
(a) FIG NO.	(b) ITEM NO.	SMR CODE	NATIONAL STOCK NUMBER	PART NUMBER	FSCM	USABLE ON CODE	U/M	QTY INC IN UNIT
						GROUP 02 BOX ASSEMBLY ADAPTER 114V058-1		
3	1	XDHZZ		BACM10T16GT	77272	PLATE, METAL CALIBRATION.....	EA	1
3	2	XDHZZ		114V3059-2	77272	COVER.....	EA	1
3	3	PAOHH	5995-00-431-8595	114V3062-1	77272	CABLE ASSEMBLY.....	EA	1
3	4	PAHZZ	5930-00-913-3641	MS90310-221	96906	SWITCH, TOGGLE	EA	1
3	5	PAHZZ	593000-476-4563	V71051NSR05N30C3 NEC	31356	SWITCH, ROTARY	EA	1
3	6	PAHHH	6615-00-133-7843	IL4V3060-1	77272	COMPONENT ASSEMBLY	EA	1
3	7	XDHZZ		AN51L-626	88044	SCREW	EA	2
3	8	XDHZZ		BACM10J4BWK	77272	PLATE, METAL CALIBRATION.....	EA	1
3	9	XDHZZ	5310-00-045-4007	MS35338-41	96906	WASHER.....	EA	1
3	10	XDHZZ		AN960D6	88044	WASHER.....	EA	1
3	11	XDHZZ		BACT1281	77272	TERMINAL, LUG	EA	1
3	12	XDHZZ		1059	70485	BUMPER	EA	4
3	13	XDHZZ		AN515-6R10	88044	SCREW	EA	1
3	14	XDHZZ		AN515-6R20	88044	SCREW	EA	1
3	15	XDHZZ	5310-00-167-0816	AN960-6	88044	WASHER.....	EA	1
3	16	XDOZZ		AN565AC4H3	88044	SETSCREWNW	A	2
3	17	PAOZZ	5355-00-472-9354	MS91528-1048	96906	KNOB	EA	1
3	18	XDHZZ		BACM10LIETF	11272	PLATE, METAL CALIBRATION.....	EA	1
3	19	XDHZZ	5310-00-843-7635	MF6001-06	15653	NUT, ANCHOR.....	EA	4
3	20	XDHZZ	5365-00-698-3422	NAS43DD1-40	80205	SPACER, SLEEVE.....	EA	1
3	21	XDHZZ	5915-00-714-4591	TY15	59730	CLAMP, TYRAP	EA	1
3	22	XDHZZ	5310-00-081-8087	MS21044N06	96906	NUT	EA	2
3	23	XDHZZ	5310-00-167-0832	AN960-6L	88044	WASHER.....	EA	4
3	24	XDHZZ		AN515-6R6	88044	SCREW	EA	4
					9			

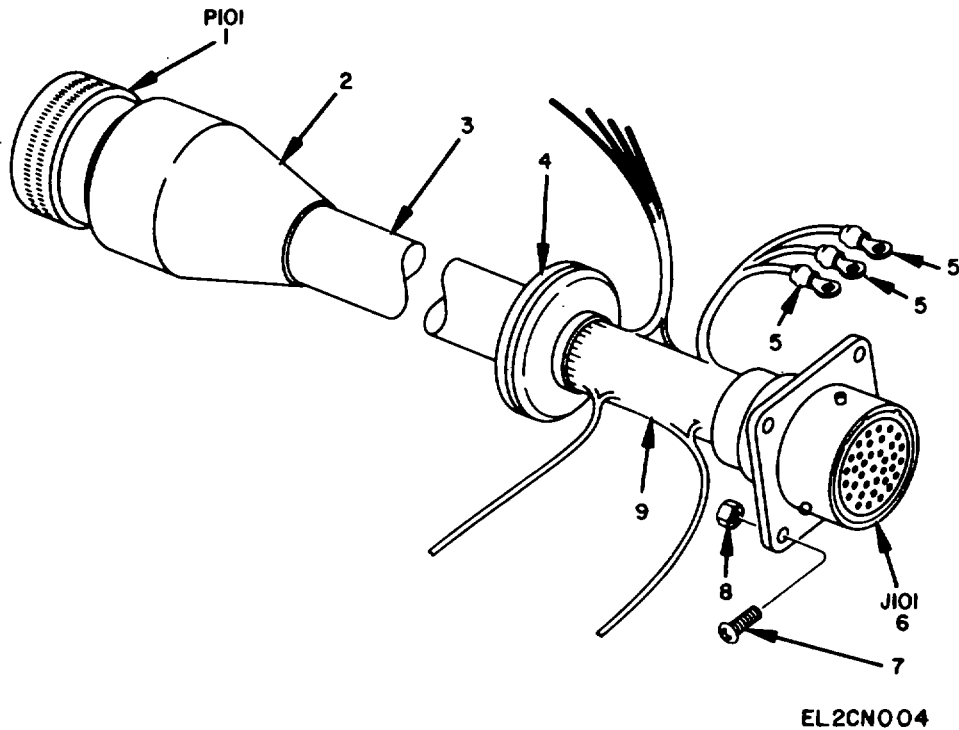
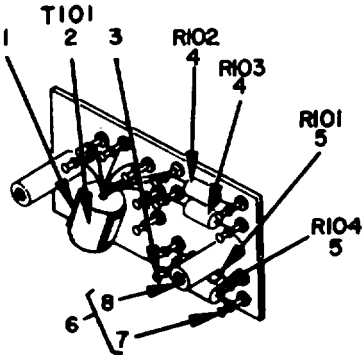

Figure 4. Cable Assembly 114V3062-1.

(1) ILLUSTRATION		(2)	(3)	(4)	(5)	(6) DESCRIPTION	(7)	(8)
(a) FIG NO.	(b) ITEM NO.	SMR CODE	NATIONAL STOCK NUMBER	PART NUMBER	FSCM	USABLE ON CODE	U/M	QTY INC IN UNIT
						GROUP 0201 CABLE ASSEMBLY 114V3062-1		
4	1	PAHZZ	5935-00-988-4349	MS3126E20-41P	96906	CONNECTOR, PLUG.....	EA	1
4	2	XDHZZ		202A153-3	08795	BOOT, HEAT, SHRINKABLE	EA	1
4	3	PAHZZ	5970-00-812-1356	M2053/5-1110	81349	SLEEVE.....	EA	1
4	4	PAHZZ	5325-00-174-9038	MS35489-20	96906	GROMMET.....	EA	1
4	5	PAHZZ	5940-00-204-8990	MS25036-111	98410	TERMINAL, LUG	EA	3
4	6	PAHZZ	5935-00-988-4231	MS3122E20-41S	96906	CONNECTOR, RECEPTACLE.....	EA	8
4	7	XDHZZ		AN515-4R6	88044	SCREW	EA	8
4	8	XDHZZ	5310-00-088-0551	MS21044N04	96906	NUT	EA	9
4	9	XDHZZ	6145-00-284-0866	2164	92194	BRAID, TUBULAR.....	EA	1



EL2CN005

Figure 5. Component Assembly 114V3060-1.

(1) ILLUSTRATION		(2)	(3)	(4)	(5)	(6)	(7)	(8)
(a) FIG NO.	(b) ITEM NO.	SMR CODE	NATIONAL STOCK NUMBER	PART NUMBER	FSCM	DESCRIPTION USABLE ON CODE	U/M	QTY INC IN UNIT
						GROUP 0202 COMPONENT ASSEMBLY 114V3060-1		
5	1	XDHZZ		100-239-0	99378	CLIP	EA	1
5	2	PAHZZ	5950-00-083-0681	DOT39	80223	TRANSFORMER.....	EA	1
5	3	XDHZZ		1042-2	11219	TERMINAL	EA	9
5	4	PAHZZ	5905-00-972-3559	RN55C4871F	81349	RESISTOR, FIXED, FILM.....	EA	2
5	5	PAHZZ	5905-00-928-8159	RN55C1692F	81349	RESISTOR, FIXED, FILM.....	EA	2
5	6	XDHZZ		114V3060-2	77272	BOARD ASSEMBLY, PRINTED CIRCUIT.....	EA	1
5	7	XDHZZ		1246-14	71279	STANDOFF	EA	2
5	8	XDHZZ	5940-00-622-1934	20342	71279	TERMINAL	EA	5

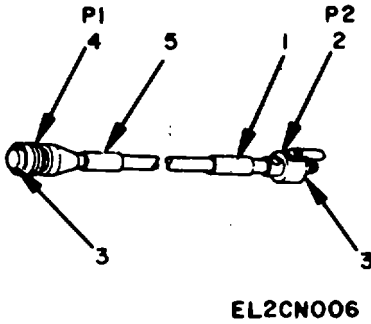

Figure 6. Cable Assembly A02VS309-2

(1) ILLUSTRATION		(2)	(3)	(4)	(5)	(6)	(7)	(8)
(a) FIG NO.	(b) ITEM NO.	SMR CODE	NATIONAL STOCK NUMBER	PART NUMBER	FSCM	DESCRIPTION USABLE ON CODE	U/M	QTY INC IN UNIT
						GROUP 08 CABLE ASSEMBLY A02VS309-2		
6	1	XDHZZ		10-359470-10	77820	BAND, IDENTIFICATION	EA	1
6	2	PAHZZ	5935-00-843-7362	MS24463	19906	CONNECTOIR, PLUG.....	EA	1
6	3	PAHZZ	5935-00-821-9839	10-70506-12	77820	CAP, PROTECTIVE	EA	2
6	4	PAHZZ	5935-00-990-2737	P106A12-3S	77820	CONECTOR, PLUG	EA	1
6	5	XDHZZ		10-359470-9	77820	BAND, IDENTIFICATION	EA	1
					12			

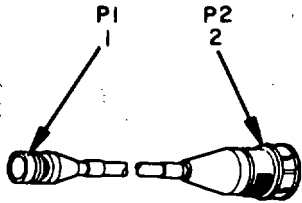

Figure 7. Cable Assembly A02VS309-3.

(1) ILLUSTRATION		(2)	(3)	(4)	(5)	(6)	(7)	(8)
(a) FIG NO.	(b) ITEM NO.	SMR CODE	NATIONAL STOCK NUMBER	PART NUMBER	FSCM	DESCRIPTION USABLE ON CODE	U/M	QTY INC IN UNIT
7	1	PAHZZ	5935-00-899-6869	MS3107A20-4P	96906	GROUP 04 CABLE ASSEMBLY A02VS309-3	EA	1
7	2	PAHZZ	5935-00-088-6765	PT06A12-3SY	77820	CONNECTOR, PLUG..... CONNECTOR, PLUG.....	EA	1
13								

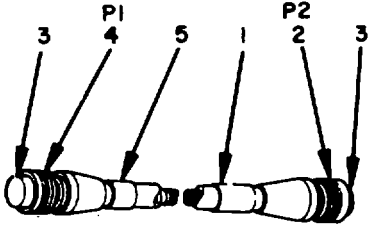
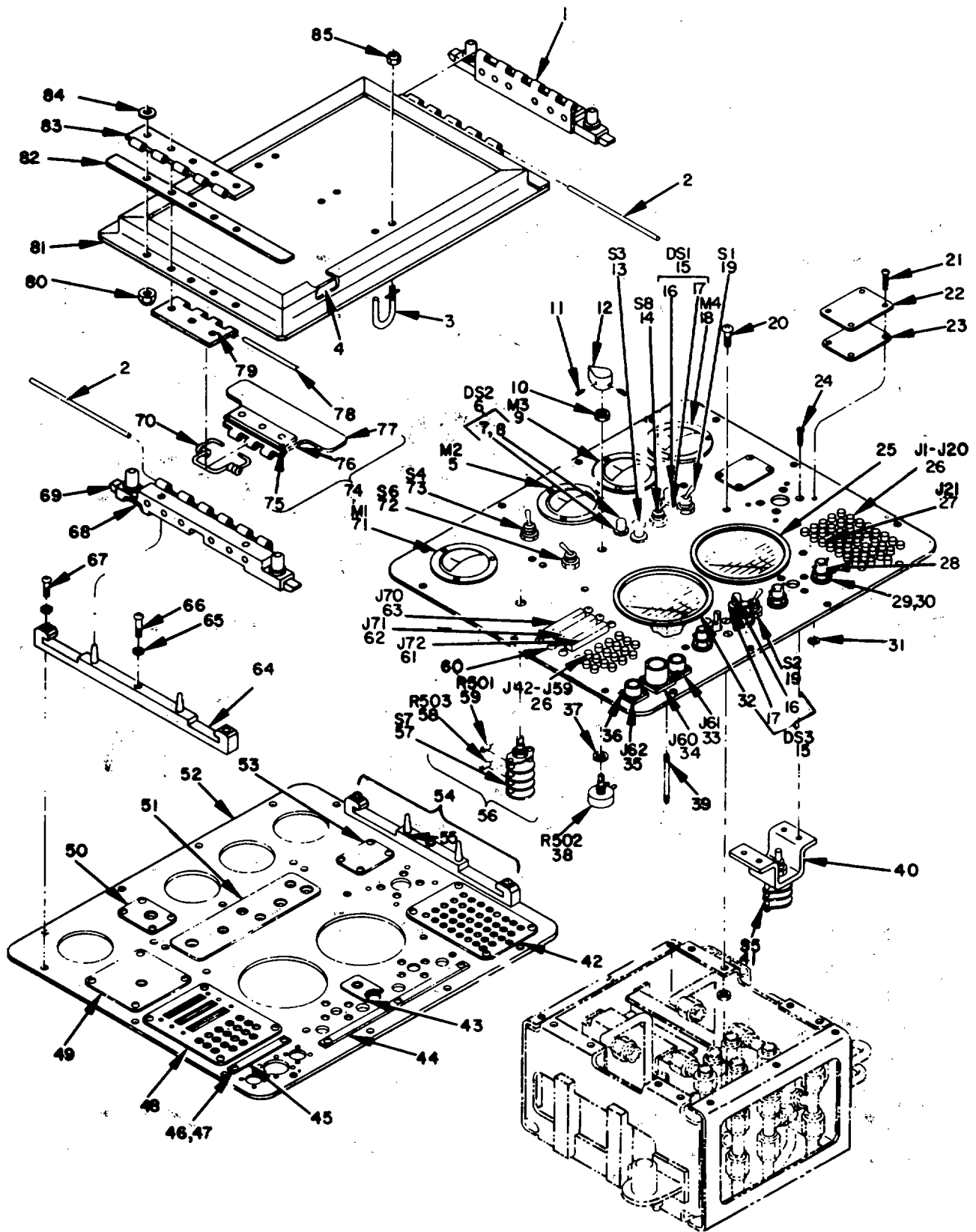

Figure 8. Cable Assembly A02VS309-1.

(1) ILLUSTRATION		(2)	(3)	(4)	(5)	(6)	(7)	(8)
(a) FIG NO.	(b) ITEM NO.	SMR CODE	NATIONAL STOCK NUMBER	PART NUMBER	FSCM	DESCRIPTION USABLE ON CODE	U/M	QTY INC IN UNIT
						GROUP 05 CABLE ASSEMBLY A02VS309-1		
8	1	XDHZZ		10-359470-20	77820	BAND IDENTIFICATION	EA	1
8	2	PAHZZ	5935-00-820-5854	PT06A20-41S	77820	CONNECTOR, PLUG.....	EA	1
8	3	PAHZZ	5935-00-887-8898	10-607000-15	04939	CAP, PROTECTIVE	EA	2
8	4	PAHZZ	5935-00-686-3700	PT06A2-41P	77820	CONNECTOR, PLUG.....	EA	1
8	5	XDHZZ		10359470-19	77820	BAND, IDENTIFICATION	EA	1
					14			



EL2CNO09

Figure 9. Panel Assembly, Front 114E5987-7 (Sheet 1 of 2).

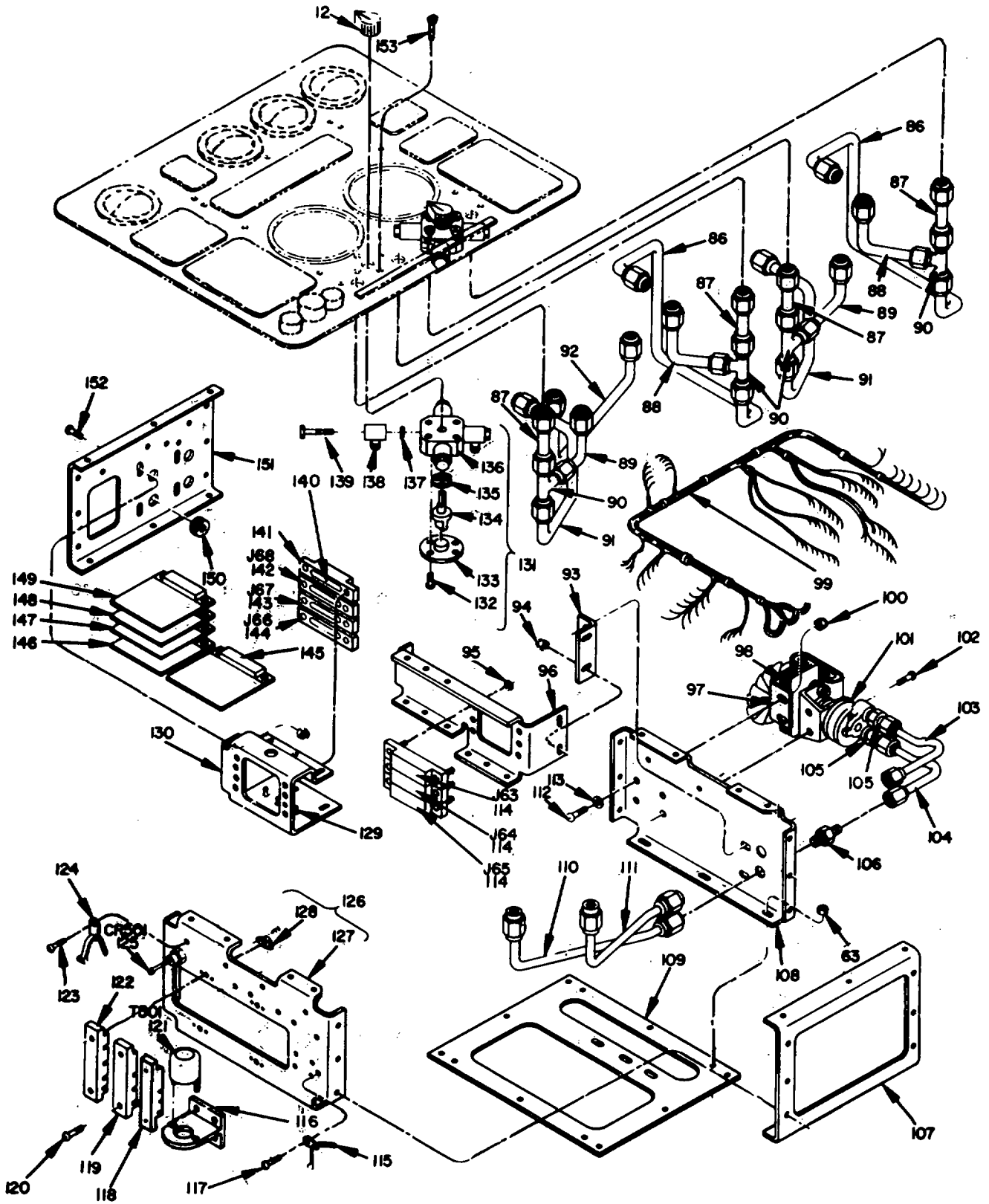

EL2CNO10

Figure 9. Panel Assembly, Front 114E5987-7 (Sheet 2 of 2).

(1) ILLUSTRATION		(2)	(3)	(4)	(5)	(6) DESCRIPTION	(7)	(8)
(a) FIG NO.	(b) ITEM NO.	SMR CODE	NATIONAL STOCK NUMBER	PART NUMBER	FSCM	USABLE ON CODE	U/M	QTY INC IN UNIT
						GROUP 06 PANEL ASSEMBLY, FRONT 114E5987-7		
9	1	XDHZZ		A02V3044-28	77272	PLATE ASSEMBLY, LATCH, RIGHT HAND ...	EA	1
9	2	XDHZZ		MS20253-2-625	96906	PIN, HINGE	EA	2
9	3	XDHZZ		A02V3044-19	77272	CLIP ASSEMBLY	EA	3
9	4	XDHZZ		A02V3044-32	77272	STRIP	EA	1
9	5	PAHZZ	6625-00-908-9102	A02VS302-1	77272	METER	EA	1
9	6	PAHHH	6210-00-084-3920	MS25256-2-327	96906	LIGHT ASSEMBLY	EA	1
9	7	PAOZZ	6240-00-155-7836	MS25237-327	96906	LAMP	EA	1
9	8	PAHZZ	6210-00-806-8845	MS25256-2	96906	LIGHT, INDICATOR	EA	1
9	9	PAHZZ	6625-00-908-9103	A02VS302-2	77272	METER	EA	1
9	10	XDHZZ		MS250827	96906	NUT	EA	1
9	11	XDOZZ		AN565AC4H3	88044	SETSCREW	EA	12
9	12	PAOZZ	5355-00-616-9604	MS91528-1P28	96906	KNOB	EA	6
9	13	PAHZZ	5930-00-815-9112	MS25089-3GR	96906	SWITCH, PUSH	EA	1
9	14	PAHZZ	5930-00-683-1629	MS24523-23	96906	SWITCH, TOGGLE SELECT	EA	1
9	14	PAHZZ	5930-00-683-1628	MS24523-22	96906	4WI1CTH, TOGGLE SELECT	EA	1
9	15	XDHHH		MS25257-3	96906	LIGHT ASSEMBLY	EA	2
9	16	PAOZZ	6240-00-892-4420	MS25252NE2D	96906	LAMP, NEON	EA	2
9	17	PAHZZ	6210-00-808-8604	MS25257-4	96906	HOUSING, LIGHT	EA	2
9	18	PAHZZ	6625-00-908-9104	A02VS302-3	77272	METER	EA	1
9	19	PAHZZ	5925-00-967-8685	MS24509-3	96906	CIRCUIT BREAKER	EA	2
9	20	XDHZZ		ANS515-6R8	88044	SCREW	EA	65
9	21	XDHZZ		ANS515C4R8	88044	SCREW	EA	4
9	22	XDHZZ		A02V3041-12	77272	PLATE, INSTRUCTION	EA	1
9	23	XDHZZ		A02V3041-13	17272	PLATE	EA	1
9	24	XDHZZ		AN505-6R8	B8044	SCREW	EA	4
9	25	PAHZZ	6685-00-908-9771	A02VS301-1	77272	GAGE, AIR	EA	1
9	26	PAHZZ	5935-00-578-3489	MS16108-2A	96906	JACK, RED TEST	EA	58
9	27	PAHZZ	5935-00-577-2336	MS16108-3A	96906	JACK, BLACK TEST	EA	1
9	28	PAHZZ	4730-00-684-0087	1012-4	00624	COUPLING, HALF	EA	4
9	29	XDHZZ		AN924-4D	88044	NUT	EA	4
9	30	XDHZZ	5310-00-167-0838	AN960-716L	88044	WASHER	EA	4
9	31	XDHZZ	5310-00-595-6425	AN960C4L	88044	WASHER	EA	4
9	32	PAHZZ	6610-00-769-6826	A02VS301-2	77272	GAGE, AIR	EA	1
9	33	PAHZZ	5935-00-080-6948	PT02CE12-3P	77820	CONNECTOR, RECEPTACLE	EA	1
9	34	PAHZZ	5930-00-988-4231	MS31ZZE20-41S	9696'	CONNECTOR, RECEPTACLE	EA	1
9	35	PAHZZ	5935-00-985-0568	PT02E12-3PY	77820	CONNECTOR, RECEPTACLE	EA	1
9	36	XDHZZ	5310-00-088-0551	MS21044N04	96906	NUT	EA	20
9	37	XDHZZ	5310-00-595-7237	AN936A616	88044	WASHER	EA	1
9	38	PAHZZ	5905-00-910-0770	A02V3075-L	17272	RESISTOR, VARIABLE	EA	1

SECTION II

TM 11-6625-646-24P

(1) ILLUSTRATION		(2)	(3)	(4)	(5)	(6)	(7)	(8)
(a) FIG NO.	(b) ITEM NO.	SMR CODE	NATIONAL STOCK NUMBER	PART NUMBER	FSCM	DESCRIPTION USABLE ON CODE	U/M	QTY INC IN UNIT
9	39	XDHZZ		A02V3044-11	77272	STUD.....	EA	6
9	40	XDHZZ		A02V3044-31	77272	BRACKET.....	EA	1
9	41	PAHZZ	5930-00-688-7868	A02V3074-2	77272	SWITCH, ROTARY	EA	1
9	42	XDHZZ		A02V3041-6	77272	PLATE, INSTRUCTION.....	EA	1
9	43	XDHZZ		A02V3041-2	77272	PLATE, INSTRUCTION.....	EA	1
9	44	XDHZZ		A02V3041-10	77272	PLATE, INSTRUCTION.....	EA	1
9	45	XDHZZ		A02V3041-14	77272	PLATE, INSTRUCTION.....	EA	1
9	46	XDHZZ	5305-00-889-2998	MS35206-216	96906	SCREW	EA	6
9	47	XDHZZ	5310-00-167-0831	AN9604L	88044	WASHER.....	EA	24
9	48	XDHZZ		A02V3041-4	77272	PLATE, INSTRUCTION.....	EA	1
9	49	XDHZZ		A02V3041-3	77272	PLATE, INSTRUCTION.....	EA	1
9	50	XDHZZ		A02V3041-11	77272	PLATE, INSTRUCTION.....	EA	1
9	51	XDHZZ		A02V3041-5	77272	PLATE, INSTRUCTION.....	EA	1
9	52	XDHZZ		A02V3040-3	77272	PANEL, FRONT	EA	1
9	53	XDHZZ		A02V3043-1	77272	PLATE, IDENTIFICATION.....	EA	1
9	54	PAHZZ	6625-00-918-1852	A02V3044-30	77272	RETAINER ASSEMBLY, LATCH, RIGHT, HAND	EA	1
9	55	XDHZZ		A02V3042-3	77272	RETAINER, LATCH, RIGHT, HAND.....	EA	1
9	56	XDHHH		114E5987-6	77272	SWITCH ASSEMBLY	EA	1
9	57	PAHZZ	5930-00-226-0564	A02V3074-1	77272	SWITCH, ROTARY	EA	1
9	58	PAHZZ	5905-00-233-7141	RN60K2741FS	81349	RESISTOR, FIXED, FILM.....	EA	1
9	59	PAHZZ	5905-00-988-2312	RN60D5622F	81349	RESISTOR, FIXED, FILM.....	EA	1
9	60	XDHZZ	5310-00-905-8451	MS21083N06	96906	NUT	EA	63
9	61	PAHZZ	5935-00-908-9798	BACC45HM7	77272	CONNECTOR, RECEPTACLE.....	EA	1
9	62	PAHZZ	5935-00-908-9796	BACC45HM3	77272	CONNECTOR, RECEPTACLE.....	EA	1
9	63	PAHZZ	5935-00-908-9797	BACC45HM6	77272	CONNECTOR, RECEPTACLE.....	EA	1
9	64	PAHZZ	6625-00-918-1857	A02V3044-29	77212	RETAINER ASSEMBLY, LATCH, RIGHT, HAND	EA	1
9	65	XDHZZ	5310-00-167-0812	AN960C10L	88044	WASHER.....	EA	3
9	66	XDHZZ		AN520C10R20	88044	SCREW	EA	1
9	67	XDHZZ		AN520C10R24	88044	SCREW	EA	2
9	68	XDHZZ		MS24585C67	96906	SPRING	EA	2
9	69	PAHZZ	6625-00-918-1861	A02V3044-27	77272	PLATE, ASSEMBLY, LATCH, LEFT HAND....	EA	1
9	70	XDHZZ		A02V3044-8	77272	SPRING.....	EA	1
9	71	PAHZZ	6625-00-908-9105	A02VS302-8	77272	METER	EA	1
9	72	PAHZZ	5930-00-683-1633	MS24523-27	96906	SWITCH, TOGGLE	EA	1
9	73	PAHZZ	5930-00-655-4241	MS24524-23	99046	SWITCH, TOGGLE	EA	1
9	74	XDHZZ		A02V3044-22	77272	RETAINER ASSEMBLY	EA	1
9	75	XDHZZ		A02V3044-15	77272	PLATE	EA	1
9	76	XDHZZ		A02V3044-20	77272	HINGE, HALF	EA	1
9	77	XDHZZ		A02V3044-16	77272	RETAINER	EA	1
9	78	XDHZZ	5315-00-066-8313	MS20253-2-350	96906	PIN, HINGIE	EA	1

SECTION II

TM 11-6625-646-24P

(1) ILLUSTRATION		(2)	(3)	(4)	(5)	(6) DESCRIPTION	(7)	(8)
(a) FIG NO.	(b) ITEM NO.	SMR CODE	NATIONAL STOCK NUMBER	PART NUMBER	FSCM	USABLE ON CODE	U/M	QTY INC IN UNIT
9	79	XDHZZ		A02V3044-26	77272	HINGE, HALF	EA	1
9	80	XDHZZ	5310-00-081-8087	MS20365-632	96906	NUT	EA	45
9	81	XDHZZ		A02V3044-24	77272	FRAME ASSEMBLY	EA	1
9	82	XAHZZ		A02V3044-14	77272	SPACER	EA	2
9	83	PAHZZ	6625-00-918-9476	A02V3044-17	77272	HINGE, HALF	EA	2
9	84	XDHZZ	5310-00-167-0832	AN960-6L	88044	WASHER	EA	26
9	85	XDHZZ		MS20365-440	96906	NUT	EA	6
9	86	PAHZZ	4710-00-914-4115	A02V3046-7	77272	TUBE ASSEMBLY	EA	2
9	87	PAHZZ	4710-00-914-4121	A02V3046-26	77272	TUBE ASSEMBLY	EA	4
9	88	PAHZZ	4710-00-914-4117	A02V3046-2	77272	TUBE ASSEMBLY	EA	2
9	89	PAHZZ	4710-00-914-4119	A02V3046-5	77212	TUBE ASSEMBLY	EA	2
9	90	PAHZZ	4730-00-722-1207	MS24402D4	96906	TEE	EA	4
9	91	XDHZZ		A02V3046-9	77272	TUBE ASSEMBLY	EA	2
9	92	PAHZZ	6625-00-937-4236	A02V3046-1	77272	TUBE ASSEMBLY	EA	1
9	93	XDHZZ		A02V3045-8	77272	BRACKET	EA	1
9	94	XDHZZ	5310-00-905-8451	MS21083N06	96906	NUT	EA	6
9	95	PAHZZ	5310-00-582-5965	MS35338-44	96906	WASHER	EA	6
9	96	XDHZZ		A02V3045-7	77272	PANEL	EA	1
9	97	XDHZZ		A02V3132-1	77272	BRACKET	EA	1
9	98	PAHZZ	6105-00-937-6467	202	24123	MOTOR, PUMP	EA	1
9	99	XDHHH		114E5987-5	77272	CABLE HARNESS ASSEMBLY	EA	1
9	100	XDHZZ		MS20364-832	96906	NUT	EA	6
9	101	PAHHH	4920-00-023-2287	0330P110-202	24123	PUMP ASSEMBLY, AIR	EA	1
9	102	XDHZZ	5305-00-984-6195	MS35206-247	96906	SCREW	EA	2
9	103	XDHZZ		A02V3046-24	77272	TUBE ASSEMBLY	EA	1
9	104	PAHZZ	4710-00-914-4123	A02V3046-23	77272	TUBE ASSEMBLY	EA	1
9	105	PAHZZ	4730-00-240-5905	AN816-4D	88044	NIPPLE	EA	2
9	106	PAHZZ	4730-00-715-0018	MS24393D4	96906	UNION	EA	2
9	107	XDHZZ		A02V3045-4	77272	PAN, REAR	EA	1
9	108	XDHZZ		A02V3045-3	77272	PAN	EA	1
9	109	XDHZZ		A02V3045-9	77272	PAN, BOTTON	EA	1
9	110	PAHZZ	6625-00-937-4238	A02V3046-4	77272	TUBE ASSEMBLY	EA	1
9	111	PAHZZ	6625-00-937-4237	A02V3046-3	77272	TUBE ASSEMBLY	EA	1
9	112	XDHZZ		AN515-8R7	88044	SCREW	EA	2
9	113	XDHZZ	5310-00-167-0833	AN960-8L	88044	WASHER	EA	6
9	114	PAHZZ	5935-00-066-5181	4527	09922	CONNECTOR, RECEPTACLE	EA	3
9	115	XDHZZ	5975-00-825-3330	TY13	59130	STRAP, CABLE	EA	4
9	116	XDHZZ		114E3029-55	77272	BRACKET	EA	1
9	117	XDHZZ		AN515-4R8	88044	SCREW	EA	16
9	118	XDHZZ		A02V3045-11	77272	RETAINER	EA	1
					19			

SECTION II

TM 11-6625-646-24P

(1) ILLUSTRATION		(2)	(3)	(4)	(5)	(6)	(7)	(8)
(a) FIG NO.	(b) ITEM NO.	SMR CODE	NATIONAL STOCK NUMBER	PART NUMBER	FSCM	DESCRIPTION USABLE ON CODE	U/M	QTY INC IN UNIT
9	119	XDHZZ		A02V3045-12	77272	RETAINER	EA	1
9	120	XDHZZ		AN515-6R16	88044	SCREW	EA	2
9	121	PAHZZ	5950-00-954-3529	TW25F26TS	02640	TRANSFORMER	EA	1
9	122	XDHZZ		A02V3045-10	77272	RETAINER	EA	1
9	123	XDHZZ		AN515-6R10	88044	SCREW	EA	17
9	124	XDHZZ	597-00-784-4591	TY15	59730	STRAP, CABLE	EA	11
9	125	XDHZZ		1N1823A	81349	DIODE	EA	1
9	126	XDHZZ		A02V3045-1	77272	PAN ASSEMBLY	EA	1
9	127	XDHZZ		A02V3045-2	77272	PAN	EA	1
9	128	XHDZZ		NAS1068CO6	81349	NUT	EA	4
9	129	XDHZZ		KTSR179-2	71468	TERMINAL	EA	3
9	130	XDHZZ		A02V3045-6	77272	BRACKET	EA	1
9	131	PAHHH	6625-00-908-9107	A02V3042-1	77272	REGULATOR, VALVE ASSEMBLY	EA	2
9	132	XDHZZ	5305-00-993-0190	AN515-4R5	86044	SCREW	EA	4
9	133	XDHZZ		A02V3042-4	77272	COVER	EA	1
9	134	XDHZZ		A02V3042-5	77272	ROTOR	EA	1
9	135	PAHZZ	5310-00-713-0528	D6-1	00141	SPRING	EA	1
9	136	XDHZZ		A02V3042-2	77272	HOUSING	EA	1
9	137	XDHZZ		AN901-4A	88044	GASKET	EA	24
9	138	PAHZZ	4730--00-433-2857	AN776-4D	88044	ELBOW	EA	12
9	139	XDHZZ		AN775-4	88044	BOLT	EA	12
9	140	XDHZZ		BACC478G1	77272	CONTACT, SOCKET	EA	100
9	141	PAHZZ	5930-00-451-5556	BACC47BF	77272	CONTACT, KEYING PLUG	EA	14
9	142	XDHZZ		BACC45HM16	77272	CONNECTOR, RECEPTACLE	EA	1
9	143	PAHZZ	5935-00-908-9799	BACC45HM11	77272	CONNECTOR, RECEPTACLE	EA	1
9	144	PAHZZ	5935-00-927-2924	BACC4HM15	77272	CONNECTOR, RECEPTACLE	EA	1
9	145	PAHHH	4920-00-019-3787	A02V3048-2	77272	COMPONENT ASSEMBLY, ACTUATOR SIMULATOR CARD	EA	1
9	146	XDHHH		A02V3060-2	77272	COMPONENT ASSEMBLY, CARD	EA	1
9	147	XDHHH		A02V3064-2	77212	COMPONENT ASSEMBLY, CARD	EA	1
9	148	PAHHH	4920-00-019-3789	A02V3068-1	77272	COMPONENT ASSEMBLY, CARD	EA	1
9	149	PAHHH	5821-00-764-5386	114E3049-47	77272	COMPONENT ASSEMBLY, AMPLIFIER CARD	EA	1
9	150	PAHZZ	5325-00-290-6163	MS35489-13	96906	GROMMET	EA	5
9	151	XDHZZ		A02V3045-5	77272	PAN, FRONT	EA	1
9	152	XDHZZ		AN515-6R6	88044	SCREW	EA	14
9	153	XDHZZ		AN505-6R5	88044	SCREW	EA	4

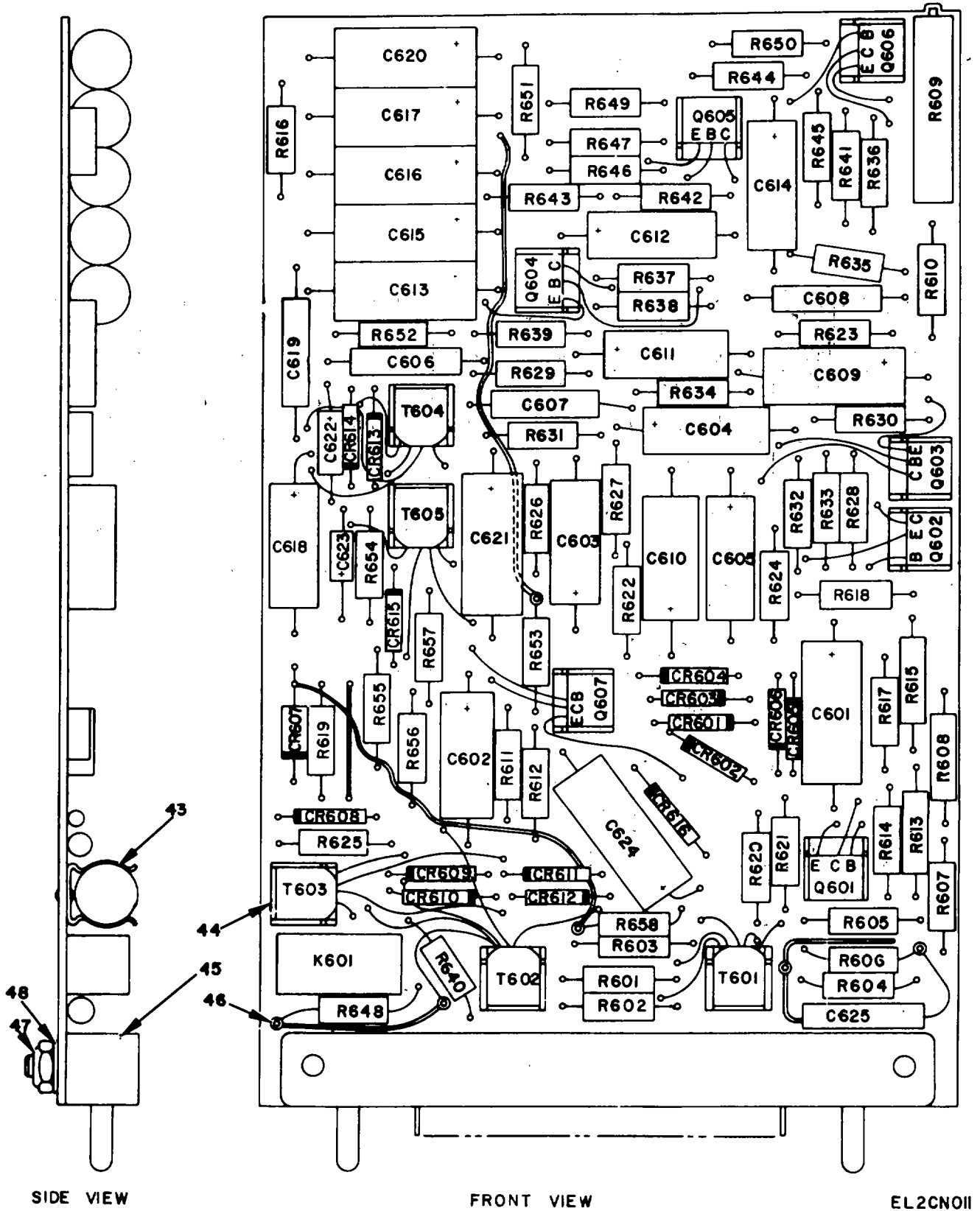

Figure 10. Component Assembly, Actuator Simulator Card A02V3048-2 (Sheet 1 of 2).

REF. DES.	ITEM NO.	REF. DES.	ITEM NO.	REF. DES.	ITEM NO.	REF. DES.	ITEM NO.	REF. DES.	ITEM NO.	REF. DES.	ITEM NO.	REF. DES.	ITEM NO.	REF. DES.	ITEM NO.
C601	1	C616	2	CR606	9	Q604	12	R612	14	R627	16	R642	16	R657	39
C602	2	C617	2	CR607	10	Q605	12	R613	17	R628	16	R643	28	R658	24
C603	3	C618	3	CR608	9	Q606	12	R614	16	R629	27	R644	28	T601	40
C604	3	C619	6	CR609	9	Q607	13	R615	17	R630	14	R645	24	T602	41
C605	3	C620	2	CR610	9	R601	14	R616	20	R631	28	R646	20	T603	42
C606	4	C621	2	CR611	9	R602	14	R617	21	R632	29	R647	33	T604	42
C607	5	C622	7	CR612	9	R603	15	R618	21	R633	30	R648	34	T605	41
C608	4	C623	7	CR613	9	R604	16	R619	22	R634	27	R649	35		
C609	2	C624	2	CR614	9	R605	14	R620	23	R635	26	R650	36		
C610	2	C625	8	CR615	9	R606	14	R621	23	R636	31	R651	27		
C611	3	CR601	9	CR616	9	R607	16	R622	24	R637	16	R652	14		
C612	3	CR602	9	K601	11	R608	17	R623	24	R638	28	R653	37		
C613	2	CR603	9	Q601	12	R609	18	R624	21	R639	20	R654	38		
C614	3	CR604	9	Q602	12	R610	19	R625	25	R640	32	R655	38		
C615	2	CR605	9	Q603	12	R611	14	R626	26	R641	24	R656	21		

EL2CNO12

Figure 10. Component Assembly, Actuator Simulator Card A02V3048-2 (Sheet 2 of 2).

(1) ILLUSTRATION		(2)	(3)	(4)	(5)	(6) DESCRIPTION	(7)	(8)
(a) FIG NO.	(b) ITEM NO.	SMR CODE	NATIONAL STOCK NUMBER	PART NUMBER	FSCM	USABLE ON CODE	U/M	QTY INC IN UNIT
						GROUP 0601 COMPONENT ASSEMBLY, ACTUATOR SIMULATOR CARD A02V3048-2		
10	1	PAHZZ	5910-00-901-9512	CSR13B337KL	81349	CAPACITOR.....	EA	1
10	2	XDHZZ		BACC11GY470	56289	CAPACITOR.....	EA	10
10	3	XDHZZ		BACC11GY220	77272	CAPACITOR.....	EA	72
10	4	PAHZZ	5910-00-903-4849	151D235X9006W2	56289	CAPACITOR.....	EA	2
10	5	PAHZZ	5910-00-903-4851	151D114X9006W2	56289	CAPACITOR SELECT.....	EA	1
10	5	PAHZZ	5910-00-903-4847	151D134X9006W2	56289	CAPACITOR SELECT.....	EA	1
10	5	PAHZZ	5910-00-903-4850	151D164X9006W2	56289	CAPACITOR SELECT.....	EA	1
10	5	PAHZZ	5910-00-903-4854	151D194X9006W2	56289	CAPACITOR SELECT.....	EA	1
10	5	PAHZZ	5910-00-903-4853	151D234X9006W2	56289	CAPACITOR SELECT.....	EA	1
10	5	PAHZZ	5910-00-903-4852	151D284X9006W2	56289	CAPACITOR SELECT.....	EA	1
10	5	PAHZZ	5910-00-903-9538	151D344X9006W2	56289	CAPACITOR SELECT.....	EA	1
10	6	XDHZZ		29F585	99017	CAPACITOR.....	EA	1
10	7	PAHZZ	5910-00-810-2621	BACC11GY1R0	77272	CAPACITOR.....	EA	2
10	8	XDHZZ		K9N10DN	05397	CAPACITOR.....	EA	1
10	9	PAHZZ	5961-00-087-6047	JAN1N645	81349	DIODE.....	EA	15
10	10	XDHZZ		1N30278	04713	DIODE.....	EA	1
10	11	PAHZZ	6625-00-908-9106	SRA2C248	99928	RELAY.....	EA	1
10	12	PAHZZ	5961-00-883-5305	2N652A	81349	TRANSISTOR.....	EA	6
10	13	PAHZZ	5961-00-686-8578	JAN2N338	81349	TRANSISTOR.....	EA	1
10	14	PAHZZ	5905-00-110-0916	RCR20G102JS	81349	RESISTOR, FIXED, COMPOSITION.....	EA	8
10	15	PAHZZ	5905-00-190-8881	RC20GF182J	81349	RESISTOR, FIXED, COMPOSITION.....	EA	1
10	16	PAHZZ	5905-00-141-0600	RCR20G822JS	81349	RESISTOR, FIXED, COMPOSITION.....	EA	7
10	17	PAHZZ	5905-00-240-3015	RNR60C1002FS	81349	RESISTOR, PRECISION.....	EA	3
10	18	XDHZZ		RT11C2P202	81349	RESISTOR, VARIABLE.....	EA	1
10	19	PAHZZ	5905-00-116-8570	RCR20G912JS	81349	RESISTOR, FIXED, COMPOSITION.....	EA	1
10	20	PAHZZ	5905-00-279-1876	RC20GF222J	81349	RESISTOR, FIXED, COMPOSITION.....	EA	3
10	21	PAHZZ	5905-00-185-8510	RC20GF103J	81349	RESISTOR, FIXED, COMPOSITION.....	EA	4
10	22	PAHZZ	5905-00-111-8357	RCR20G681JS	81349	RESISTOR, FIXED, COMPOSITION.....	EA	1
10	23	PAHZZ	5905-00-104-8336	RCR20G104JS	81349	RESISTOR, FIXED, COMPOSITION.....	EA	2
10	24	PAHZZ	5905-00-279-3504	RC20GF472J	81349	RESISTOR, FIXED, COMPOSITION.....	EA	5
10	25	PAHZZ	5905-00-106-9344	RCR20G101JS	81349	RESISTOR, FIXED, COMPOSITION.....	EA	1
10	26	PAHZZ	5905-00-279-2019	RC20GF512J	81349	RESISTOR, FIXED, COMPOSITION.....	EA	2
10	27	PAHZZ	5905-00-279-1880	RC20GF272J	81349	RESISTOR, FIXED, COMPOSITION.....	EA	3
10	28	PAHZZ	5905-00-279-2616	RC20GF153J	81349	RESISTOR, FIXED, COMPOSITION.....	EA	4
10	29	PAHZZ	5905-00-171-2001	RC20GF362J	81349	RESISTOR, FIXED, COMPOSITION.....	EA	1
10	30	PAHZZ	5905-00-279-3499	RC20GF273J	81349	RESISTOR, FIXED, COMPOSITION.....	EA	1
10	31	PAHZZ	5905-00-279-1749	RC20GF625J	81349	RESISTOR, FIXED, COMPOSITION.....	EA	1
10	32	PAHZZ	5905-00-171-2003	RC20GF204J	81349	RESISTOR, FIXED, COMPOSITION.....	EA	1
					23			

SECTION II

TM 11-6625-646-24P

(1) ILLUSTRATION		(2)	(3)	(4)	(5)	(6) DESCRIPTION	(7)	(8)
(a) FIG NO.	(b) ITEM NO.	SMR CODE	NATIONAL STOCK NUMBER	PART NUMBER	FSCM	USABLE ON CODE	U/M	QTY INC IN UNIT
10	33	PAHZZ	5905-00-279-3505	RC20GF392J	81349	RESISTOR, FIXED, COMPOSITION.....	EA	1
10	34	PAHZZ	5905-00-279-2019	RC20GF512J	81349	RESISTOR, FIXED, COMPOSITION, SELECT	EA	1
10	34	PAHZZ	5905-00-141-1116	RCR20G562JS	81349	RESISTOR, FIXED, COMPOSITION, SELECT	EA	1
10	34	PAHZZ	5905-00-279-2673	RC20GF622J	81349	RESISTOR, FIXED, COMPOSITION, SELECT	EA	1
10	34	PAHZZ	5905-00-279-3503	RC20GF682J	81349	RESISTOR, FIXED, COMPOSITION, SELECT	EA	1
10	34	PAHZZ	5905-00-116-8568	RCR20G752JS	81349	RESISTOR, FIXED, COMPOSITION, SELECT	EA	1
10	34	PAHZZ	5905-00-299-1971	RC20GF822J	81349	RESISTOR, FIXED, COMPOSITION, SELECT	EA	1
10	35	PAHZZ	5905-00-171-2004	RC20GF223J	81349	RESISTOR, FIXED, COMPOSITION.....	EA	1
10	36	PAHZZ	5905-00-279-3519	RC20GF220J	81349	RESISTOR, FIXED, COMPOSITION.....	EA	1
10	37	PAHZZ	5905-00-111-4734	RCR20G470JS	81349	RESISTOR, FIXED, COMPOSITION.....	EA	1
10	38	PAHZZ	5905-00-249-3661	RC20GF683J	81349	RESISTOR, FIXED, COMPOSITION.....	EA	2
	39	PAHZZ	5905-00-279-1877	RC20GF242J	81349	RESISTOR, FIXED, COMPOSITION.....	EA	1
10	40	PAHZZ	5950-00-851-4221	DOT25	80223	TRANSFORMER	EA	1
10	41	PAHZZ	5950-00-799-4163	DOT36	80223	TRANSFORMER	EA	2
10	42	PAHZZ	5950-00-684-4412	DOT23	80223	TRANSFORMER	EA	2
10	43	XDHZZ		100-239-0	99378	CLAMP	EA	12
10	44	PAHZZ	5950-00-715-4638	DOTSH	80223	SHIELD.....	EA	5
10	45	PAHZZ	5935-00-903-2445	4528	09922	CONNECTOR, RECEPTACLE.....	EA	1
10	46	PAHZZ	5940-00-956-4751	X2043B	71279	STANDOFF	EA	6
10	47	PAHZZ	5310-00-905-8451	MS21083N06	96906	NUT	EA	2
10	48	PAHZZ	5310-00-638-9857	AN960C6L	88044	WASHER.....	EA	2
					24			

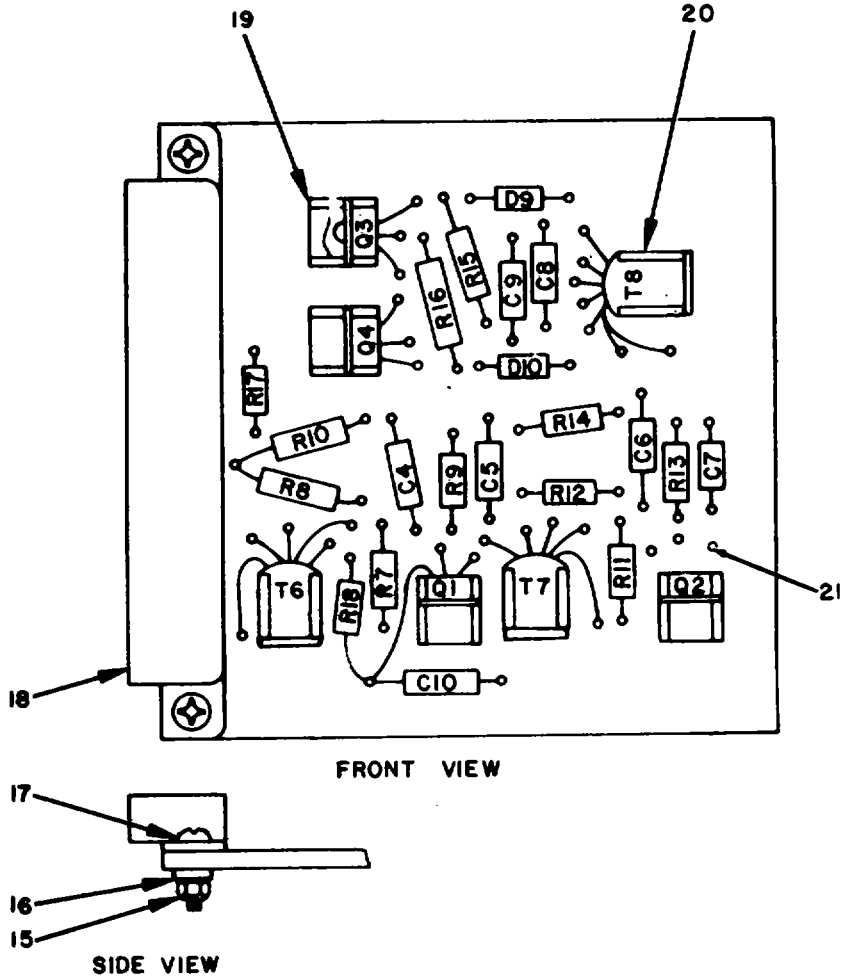

REF DES	ITEM NO	REF DES	ITEM NO	REF DES	ITEM NO	REF DES	ITEM NO	REF DES	ITEM NO
C4	1	C10	4	Q4	6	R12	7	R18	13
C5	2	D9	5	R7	7	R13	8	T6	14
C6	1	D10	5	R8	7	R14	10	T7	14
C7	2	Q1	6	R9	8	R15	11	T8	14
C8	3	Q2	6	R10	9	R16	11		
C9	3	Q3	6	R11	7	R17	12		

EL2CNO13

Figure 11. Component Assembly, Amplifier Card 1143049-47

SECTION II

TM 11-6625-646-24P

(1) ILLUSTRATION		(2)	(3)	(4)	(5)	(6) DESCRIPTION	(7)	(8)
(a) FIG NO.	(b) ITEM NO.	SMR CODE	NATIONAL STOCK NUMBER	PART NUMBER	FSCM	USABLE ON CODE	U/M	QTY INC IN UNIT
						GROUP 0602 COMPONENT ASSEMBLY, AMPLIFIER CARD 114E3049-47		
11	1	PAHZZ	5910-00-007-2004	M39003-01-0388	81349	CAPACITOR.....	EA	2
11	2	PAHZZ	5910-00-104-0144	150D105X9035A2	56289	CAPACITOR.....	EA	2
11	3	PAHZZ	5910-00-820-9255	150D154X9035A2	56289	CAPACITOR.....	EA	2
11	4	PAHZZ	5910-00-913-4638	WE2-473	99515	CAPACITOR.....	EA	1
11	5	PAHZZ	5961-00-087-6047	JAN1N645	81349	DIODE	EA	2
11	6	PAHZZ	5961-00-883-5305	2N652A	81349	TRANSISTOR.....	EA	4
11	7	PAHZZ	5905-00-185-8510	RC20GF103J	81349	RESISTOR, FIXED COMPOSITION.....	EA	4
11	8	PAHZZ	5905-00-113-4856	RCR20G200JS	81349	RESISTOR, FIXED, COMPOSITION SELECT	EA	1
11	8	PAHZZ	5905-00-279-3519	RC20GF220J	81349	RESISITOR, FIXED, COMPOSITION SELECT FOR R9 ONLY.....	EA	2
11	8	PAHZZ	5905-00-279-1750	RC20GF240J	81349	RESISTOR, FIXED, COMPOSITION SELECT	EA	1
11	8	PAHZZ	5905-00-116-8561	RCR20G270JS	81349	RESISTOR, FIXED, COMPOSITION SELECT	EA	1
11	8	PAHZZ	5905-00-935-8540	RCR20G300JS	81349	RESISTOR, FIXED, COMPOSITION SELECT	EA	1
11	8	PAHZZ	5905-00-192-4490	RC20GF330J	81349	RESISTOR, FIXED, COMPOSITION SELECT	EA	1
11	8	PAHZZ	5905-00-279-1885	RC20GF360J	81349	RESISTOR, FIXED, COMPOSITION SELECT	EA	1
11	8	PAHZZ	5905-00-141-1118	RCR20G390JS	81349	RESISTOR, FIXED, COMPOSITION SELECT	EA	1
11	8	PAHZZ	5905-00-279-1887	RC20GF430J	81349	RESISTOR, FIXED, COMPOSITION SELECT	EA	1
11	8	PAHZZ	5905-00-111-4734	RCR20G470JS	81349	RESISTOR, FIXED, COMPOSITION SELECT	EA	1
11	8	PAHZZ	5905-00-114-5438	RCR20G510JS	81349	RESISTOR, FIXED, COMPOSITION SELECT	EA	1
11	8	PAHZZ	5905-00-279-1897	RC20GF560J	81349	RESISTOR, FIXED, COMPOSITION SELECT	EA	1
11	8	PAHZZ	5905-00-279-1760	RC20GF620J	81349	RESISTOR, FIXED, COMPOSITION SELECT	EA	1
11	8	PAHZZ	5905-00-116-8566	RCR20G680JS	81349	RESISTOR, FIXED, COMPOSITION SELECT	EA	1
11	8	PAHZZ	5905-00-279-1758	RC20GF750J	81349	RESISTOR, FIXED, COMPOSITION SELECT	EA	1
11	8	PAHZZ	5905-00-279-1894	RC20GF820	81349	RESISTOR, FIXED, COMPOSITION SELECT	EA	1
11	8	PAHZZ	5905-00-279-3516	RC20GF910J	81349	RESISTOR, FIXED, COMPOSITION SELECT	EA	1
11	8	PAHZZ	5905-00-106-9344	RCR20G101JS	81349	RESISTOR, FIXED, COMPOSITION SELECT	EA	1
11	8	PAHZZ	5905-00-279-3522	RC20GF160J	81349	RESISTOR, FIXED, COMPOSITION SELECT	EA	1
11	8	PAHZZ	5905-00-114-5381	RCR20G180JS	81349	RESISTOR, FIXED, COMPOSITION SELECT	EA	1
11	9	PAHZZ	5905-00-279-3506	RC20GF332J	81349	RESISTOR, FIXED, COMPOSITION.....	EA	1
11	10	PAHZZ	5905-00-279-1880	RC20GF272J	81349	RESISTOR, FIXED, COMPOSITION.....	EA	1
11	11	PAHZZ	5905-00-988-2319	RN60D1502F	81349	RESISTOR, FIXED, FILM.....	EA	2
11	12	PAHZZ	5905-00-110-0916	RCR20G102JS	81349	RESISTOR, FIXED, COMPOSITION.....	EA	1
11	13	PAHZZ	5905-00-190-8880	RC20GF122J	81349	RESISTOR, FIXED, COMPOSITION.....	EA	1
11	14	PAHZZ	5905-00-851-4221	DOT25	80223	TRANSFORMER.....	EA	3
11	15	XDHZZ	5310-00-905-8451	MS21083N06	96906	NUT	EA	2
11	16	XDHZZ	5310-00-167-0832	AN960-6L	88044	WASHER.....	EA	2
11	17	XDHZZ		AN515-6R8	880044	SCREW	EA	2
11	18	XDHZZ		BACC45HL3	77272	CONNECTOR, PLUG SELECT.....	EA	1
11	18	PAHZZ	5935-00-954-6431	114E3049-8	77272	CONNECTOR, PLUG SELECT.....	EA	1

SECTION II

TM 11-6625-646-24P

(1) ILLUSTRATION		(2)	(3)	(4)	(5)	(6)	(7)	(8)
(a) FIG NO.	(b) ITEM NO.	SMR CODE	NATIONAL STOCK NUMBER	PART NUMBER	FSCM	DESCRIPTION USABLE ON CODE	U/M	QTY INC IN UNIT
11	19	XDHZZ		100-239-0	99378	CLAMP	EA	1
11	20	PAHZZ	5950-00-715-4638	DOTSH	80223	SHIELD.....	EA	3
11	21	XDHZZ	5940-00-956-4751	X2043B6	71279	STANDOFF	EA	3
					28			

REF DES	ITEM NO	REF DES	ITEM NO	REF DES	ITEM NO	REF DES	ITEM NO
C201	1	CR202	4	R204	7	R209	10
C202	2	R201	5	R205	8	R210	10
C203	3	R202	5	R206	9		
CR201	4	R203	6	R207	9		

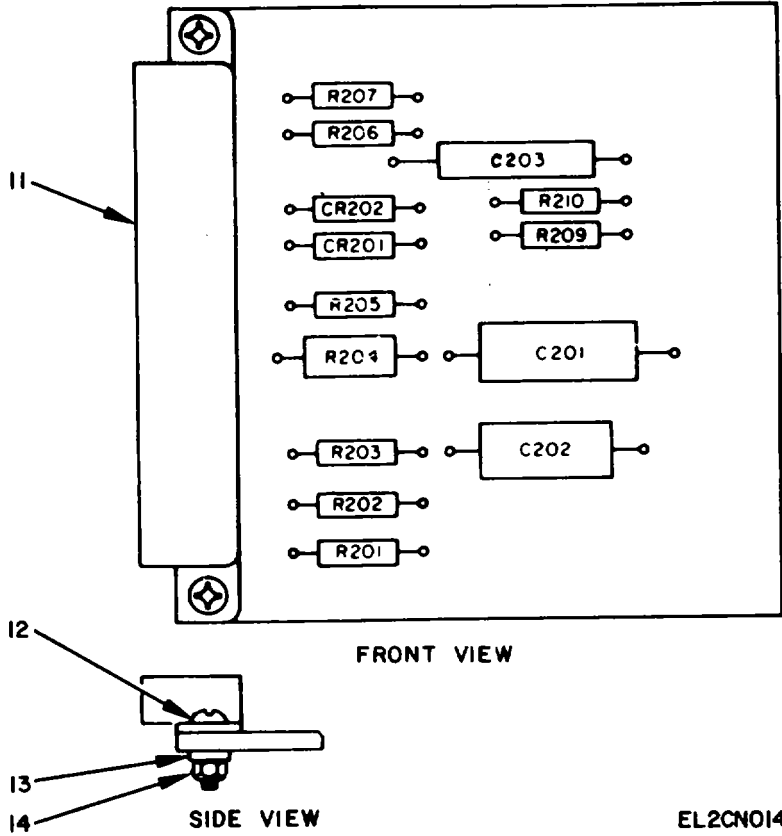

Figure 12. Component Assembly, Card A02V3060-2.

SECTION II

TM 11-6625-646-24P

(1) ILLUSTRATION		(2)	(3)	(4)	(5)	(6) DESCRIPTION	(7)	(8)
(a) FIG NO.	(b) ITEM NO.	SMR CODE	NATIONAL STOCK NUMBER	PART NUMBER	FSCM	USABLE ON CODE	U/M	QTY INC IN UNIT
						GROUP 0603 COMPONENT ASSEMBLY, CARD A02V3060-2		
12	1	PAHZZ	5910-00-070-3395	109D826X9050T2	56289	CAPACITOR.....	EA	1
12	2	XDHZZ		BACC11GY470	77272	CAPACITOR.....	EA	1
12	3	PAHZZ	5961-00-682-3621	29F408	24446	CAPACITOR.....	EA	1
12	4	PAHZZ	5961-00-087-6047	JAN1N645	81349	DIODE	EA	2
12	5	PAHZZ	5905-00-190-8874	RC20GF125J	81349	RESISTOR, FIXED, COMPOSITION.....	EA	2
12	6	PAHZZ	5905-00-171-1999	RC20GF821J	81349	RESISTOR, FIXED, COMPOSITION.....	EA	1
12	7	PAHZZ	5905-00-081-6135	RW69V200	81349	RESISTOR, FIXED, WIRE WOUND	EA	1
12	8	PAHZZ	5905-00-988-2307	RN60D1003F	81349	RESISTOR, FIXED, FILM.....	EA	1
12	9	PAHZZ	5905-00-279-1880	RC20GF272J	81349	RESISTOR, FIXED, COMPOSITION.....	EA	2
12	10	PAHZZ	5905-00-192-3971	RC20GF331J	81349	RESISTOR, FIXED, COMPOSITION.....	EA	2
12	11	PAHZZ	5935-00-908-9792	BACC45HL15	77272	CONNECTOR, PLUG.....	EA	1
12	12	XDHZZ		AN515C6R8	88044	SCREW	EA	2
12	13	PAHZZ	5310-00-638-9857	AN960C6L	88044	WASHER.....	EA	2
12	14	PAHZZ	5310-00-905-8451	MS21083N06	96906	NUT	EA	2
					31			

REF DES	ITEM NO	REF DES	ITEM NO	REF DES	ITEM NO	REF DES	ITEM NO
CR401	1	R401	2	R405	3	T402	7
CR402	1	R402	3	R406	4		
CR403	1	R403	3	R407	5		
CR404	1	R404	3	T401	6		

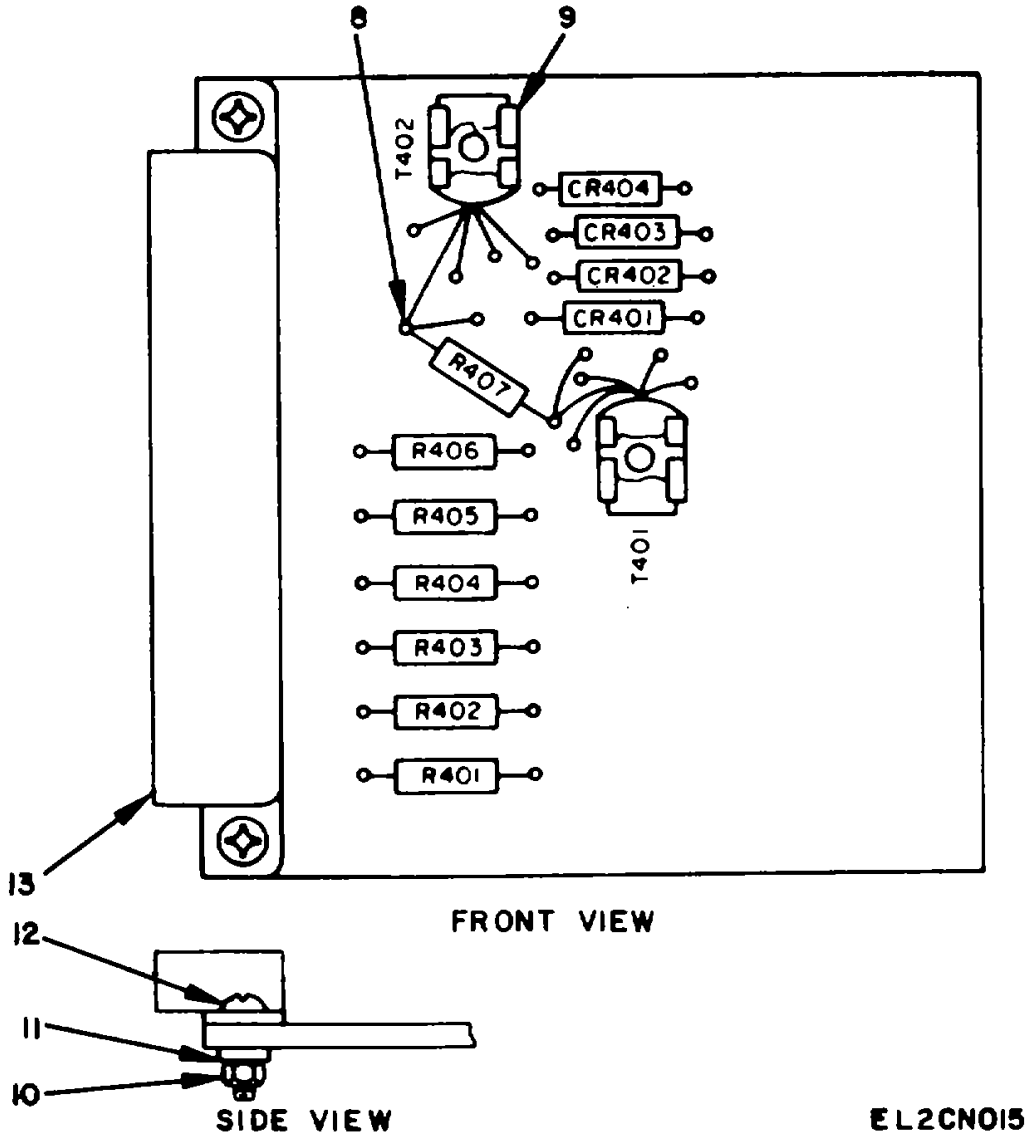
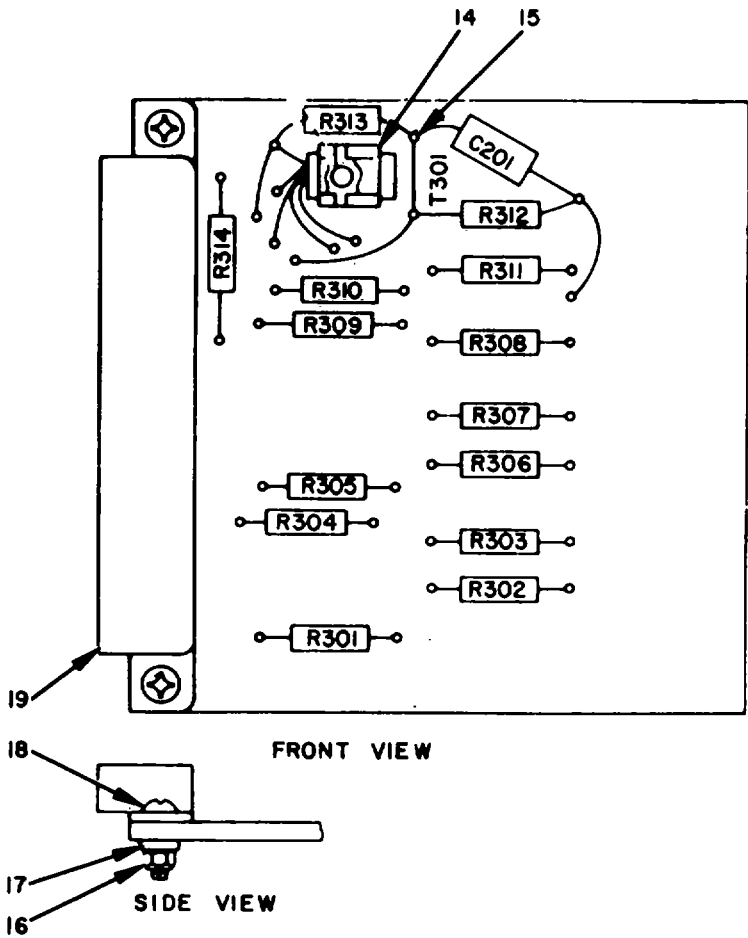

Figure 13. Component Assembly, Card A02V3068-1.

(1) ILLUSTRATION		(2)	(3)	(4)	(5)	(6) DESCRIPTION	(7)	(8)
(a) FIG NO.	(b) ITEM NO.	SMR CODE	NATIONAL STOCK NUMBER	PART NUMBER	FSCM	USABLE ON CODE	U/M	QTY INC IN UNIT
						GROUP 0604 COMPONENT ASSEMBLY, CARD A02V3068-1		
13	1	PAHZZ	5961-00-087-6047	JAN1N645	81349	DIODE	EA	4
13	2	PAHZZ	5905-00-279-2517	RC20GF394J	81349	RESISTOR, FIXED, COMPOSITION.....	EA	1
13	3	PAHZZ	5905-00-279-3502	RC20GF123J	81349	RESISTOR, FIXED, COMPOSITION.....	EA	4
13	4	PAHZZ	5905-00-121-4953	RCR20G134JS	81349	RESISTOR, FIXED, COMPOSITION.....	EA	1
13	5	PAHZZ	5905-00-279-3516	RC20GF910J	81349	RESISTOR, FIXED, COMPOSITION.....	EA	1
13	6	PAHZZ	5950-00-648-4412	DOT23	80223	TRANSFORMER.....	EA	1
13	7	PAHZZ	5950-00-851-4221	DOT25	80223	TRANSFORMER.....	EA	1
13	8	XDHZZ	5940-00-956-4751	X2043B	71279	STANDOFF	EA	2
13	9	XDHZZ		100-239-0	99378	CLAMP	EA	2
13	10	XOHZZ	5310-00-905-8451	MS21083N06	96906	NUT	EA	2
13	11	XDHZZ	5310-00-638-9857	AN960C6L	88044	WASHER.....	EA	2
13	12	XOHZZ		AN515C6R8	88044	SCREW	EA	2
13	13	PAHZZ	5930-00-908-9794	BACC45HL16	81205	CONNECTOR, PLUG.....	EA	1
					33			



REF DES	ITEM NO	REF DES	ITEM NO	REF DES	ITEM NO	REF DES	ITEM NO
C201	1	R304	4	R308	6	R312	10
R301	2	R305	5	R309	7	R313	11
R302	3	R306	3	R310	8	R314	12
R303	3	R307	3	R311	9	T301	13

EL2CNO16

Figure 14. Component Assembly, Card A02V3064-2.

SECTION II

TM 11-6625-646-24P

(1) ILLUSTRATION		(2)	(3)	(4)	(5)	(6) DESCRIPTION	(7)	(8)
(a) FIG NO.	(b) ITEM NO.	SMR CODE	NATIONAL STOCK NUMBER	PART NUMBER	FSCM	USABLE ON CODE	U/M	QTY INC IN UNIT
						GROUP 0605 COMPONENT ASSEMBLY, CARD A02V3064-2		
14	1	PAHZZ	5910-00-934-2775	WE1-1540	99515	CAPACITOR.....	EA	1
14	2	PAHZZ	5905-00-279-1872	RC20GF165J	81349	RESISTOR, FIXED, COMPOSITION.....	EA	1
14	3	PAHZZ	5905-00-110-0196	RCR20G102JS	81349	RESISTOR, FIXED, COMPOSITION.....	EA	4
14	4	PAHZZ	5905-00-452-0773	RN60K8250FS	81349	RESISTOR, FIXED, FILM.....	EA	1
14	5	PAHZZ	5905-00-192-3876	RN60K1503FS	81349	RESISTOR, FIXED, FILM.....	EA	1
14	6	PAHZZ	5905-00-988-2309	RN60D10R0F	81349	RESISTOR, FIXED, FILM.....	EA	1
14	7	PAHZZ	5905-00-689-5059	RN60D5491F	81349	RESISTOR, FIXED, FILM.....	EA	1
14	8	PAHZZ	5905-00-988-2280	RN60D2001F	81349	RESISTOR, FIXED, FILM.....	EA	1
14	9	PAHZZ	5905-00-763-6502	RN60D2800F	81349	RESISTOR, FIXED, FILM.....	EA	1
14	10	PAHZZ	5905-00-279-3504	RC20GF472J	81349	RESISTOR, FIXED, COMPOSITION.....	EA	1
14	11	PAHZZ	5905-00-279-1751	RC20GF302J	81349	RESISTOR, FIXED, COMPOSITION.....	EA	1
14	12	XDHZZ		BACR14CJ393	77272	RESISTOR, FIXED, COMPOSITION.....	EA	1
14	13	PAHZZ	5950-00-648-4412	DOT23	80223	TRANSFORMER.....	EA	1
14	14	XDHZZ		100-239-0	99378	CLAMP.....	EA	1
14	15	XDHZZ	5940-00-956-4751	X2043B	71279	STANDOFF.....	EA	4
14	16	XDHZZ	5310-00-905-8451	MS21083N06	96906	NUT.....	EA	2
14	17	XDHZZ	5310-00-638-9857	AN960C6L	88044	WASHER.....	EA	2
14	18	XDHZZ		AN515C6R8	88044	SCREW.....	EA	2
14	19	PAHZZ	5935-00-908-9793	BACC45HL11	81205	CONNECTOR, PLUG.....	EA	1
					35			

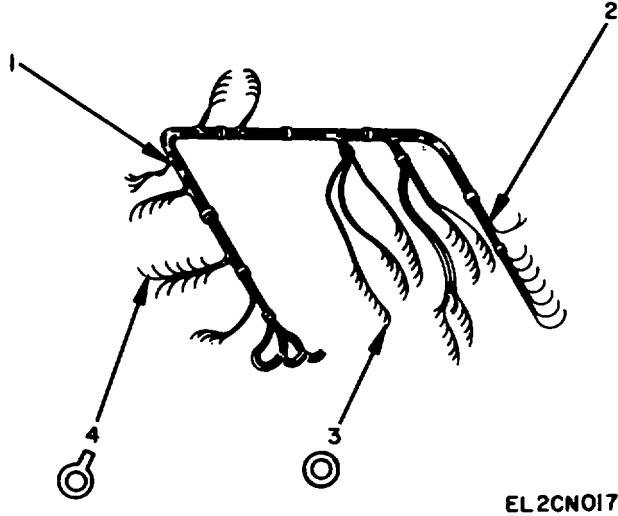
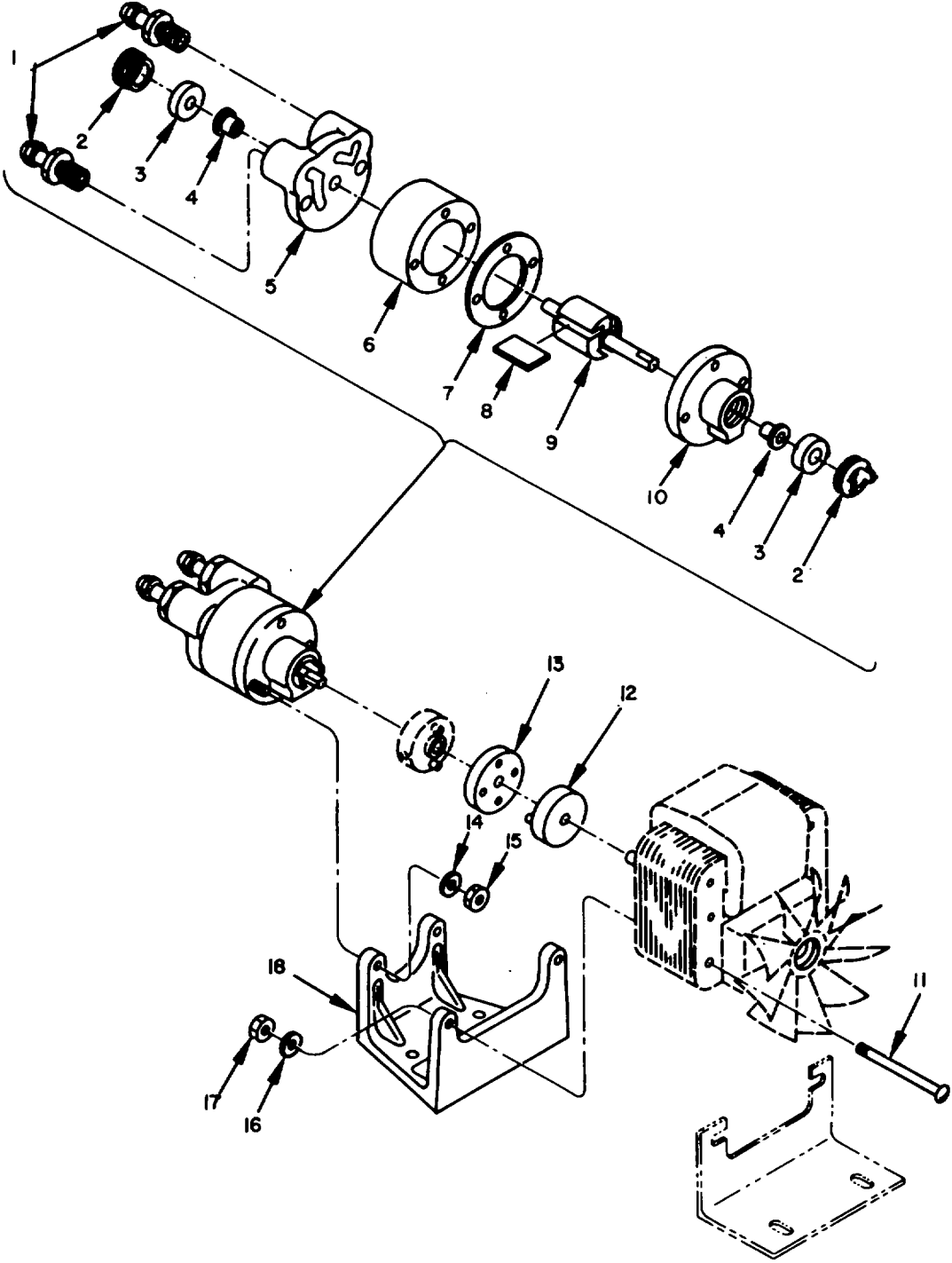

Figure 15. Cable Harness 114E5987-5.

(1) ILLUSTRATION		(2)	(3)	(4)	(5)	(6)	(7)	(8)
(a) FIG NO.	(b) ITEM NO.	SMR CODE	NATIONAL STOCK NUMBER	PART NUMBER	FSCM	DESCRIPTION USABLE ON CODE	U/M	QTY INC IN UNIT
						GROUP 0606 CABLE HARNESS 114E5987-5		
15	1	XDHZZ	5940-00-232-5209	320559	00779	SLEEVE.....	EA	4
15	2	XDHZZ	5970-00-842-1235	325009	00779	SLEEVE.....	EA	2
15	3	XDHZZ	5940-00-688-9151	323930	00779	FERRULE.....	EA	2
15	4	XDHZZ	5940-00-258-2112	31883	00779	TERMINAL, LUG.....	EA	11
					36			



EL2CNO18

Figure 16. Pump Assembly, Air 0330P110-202.

SECTION II

TM 11-6625-646-24P

(1) ILLUSTRATION		(2)	(3)	(4)	(5)	(6) DESCRIPTION	(7)	(8)
(a) FIG NO.	(b) ITEM NO.	SMR CODE	NATIONAL STOCK NUMBER	PART NUMBER	FSCM	USABLE ON CODE	U/M	QTY INC IN UNIT
						GROUP 0607 PUMP ASSEMBLY, AIR 0330P110-202		
16	1	XDHZZ		AB416A	24123	NIPPLE, HOSE.....	EA	2
16	2	PAHZZ	5340-00-937-5816	AD480	24123	CAP	EA	2
16	3	PAHZZ	4320-00-937-6433	AD449	24123	BEARING	EA	2
16	4	PAHZZ	3120-00-937-4234	A0439	24123	BUSHING	EA	2
16	5	PAHZZ	6625-00-937-4235	AD484C	24123	PLATE, DEAD END.....	EA	1
16	6	XDHZZ		AD441A	24123	BODY	EA	1
16	7	XDHZZ		AD448	24123	GASKET, BODY SPACER	EA	1
16	8	PAHZZ	4320-00-937-6432	AD447	24123	VANE.....	EA	3
16	9	PAHZZ	4320-00-937-6431	AD444	24123	ROTOR ASSEMBLY	EA	1
16	10	PAHZZ	6625-00-937-4233	AD407A	24123	PLATE, DRIVE END.....	EA	1
16	11	XDHZZ		AN515C6R32	88044	SCREW	EA	2
16	12	PAHZZ	4320-00-937-6435	AD503	24123	FLANGE, PUMP MOTOR COUPLING	EA	2
16	13	PAHZZ	4320-00-937-6434	AD455	24123	DISK, COUPLING	EA	2
16	14	XDHZZ	5310-00-045-3296	MS35338-43	96906	WASHER.....	EA	2
16	15	XDHZZ	5310-00-934-9765	MS35650-304	96906	NUT	EA	2
16	16	XDHZZ		MS35338-4	96906	WASHER.....	EA	2
16	17	XDHZZ		AN340C6	88044	NUT	EA	2
16	18	XDHZZ		207	24123	BRACKET, MOUNTING	EA	1
					39			

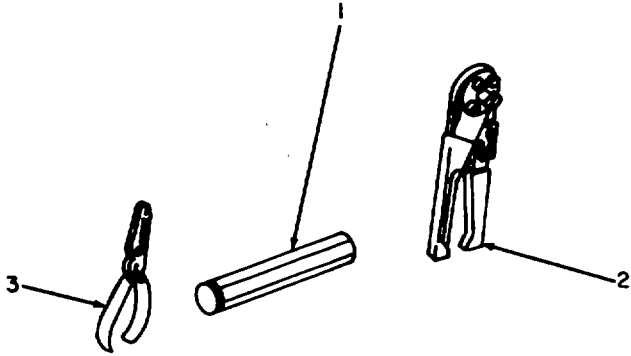

EL2CNO19

Figure 17. Special Tools.

(1) ILLUSTRATION		(2)	(3)	(4)	(5)	(6)	(7)	(8)
(a) FIG NO.	(b) ITEM NO.	SMR CODE	NATIONAL STOCK NUMBER	PART NUMBER	FSCM	DESCRIPTION USABLE ON CODE	U/M	QTY INC IN UNIT
						GROUP 07 SPECIAL TOOLS		
17	1	PEOZZ	5120-00-765-3688	11-6900	77820	CONTACT, REMOVAL KIT	EA	1
17	2	PEOZZ	5120-00-856-3732	MS3191-3	96906	TOOL, CRIMPING	EA	1
17	3	PEOZZ	5120-00-765-3689	11-6782	77820	TOOL, INSERTION	EA	1
						40		

SECTION IV

TM 11-6625-646-24P

NATIONAL STOCK NUMBER AND PART NUMBER INDEX

NOTE: LATEST NATIONAL STOCK NUMBER AND PART NUMBER ASSIGNMENTS ARE INCLUDED AT END OF INDEX

STOCK NUMBER	FIG.	ITEM	STOCK NUMBER	FIG.	ITEM
4920-00-019-3789	9	148	5905-00-279-3504	14	10
4920-00-023-2287	9	101	5905-00-279-3505	10	33
5310-00-045-3296	16	14	5905-00-279-3506	11	9
5310-00-045-4007	3	9	5905-00-279-3516	11	8
5935-00-066-5181	9	114	5905-00-279-3516	13	5
5910-00-070-3395	12	1	5905-00-279-3519	10	36
			5905-00-279-3519	11	8
			5905-00-279-3522	11	8
5935-00-080-6948	9	33	6145-00-284-0866	4	9
5905-00-081-6135	12	7	5905-00-299-1971	10	34
5310-00-081-8087	3	22	5995-00-431-8595	3	3
5310-00-081-8087	9	80	4730-00-433-2857	9	138
6210-00-084-3920	9	6	5355-00-472-9354	3	17
5310-00-088-0551	4	8	5935-00-577-2336	9	27
5310-00-088-0551	9	36	5310-00-582-5965	9	95
5935-00-088-6775	7	2	5310-00-595-6425	9	31
6615-00-133-7838	1	2	5310-00-595-7237	9	37
6615-00-133-7843	3	6	5355-00-616-9604	9	12
6240-00-155-7836	9	7	5940-00-622-1934	5	8
5310-00-167-0812	9	65	5310-00-638-9857	10	48
5310-00-167-0816	3	15	5310-00-638-9857	12	13
5310-00-167-0831	9	47	5310-00-638-9857	13	11
5310-00-167-0832	3	23	5310-00-638-9857	14	17
5310-00-167-0832	9	84	5930-00-655-4241	9	73
5310-00-167-0832	11	16	5930-00-683-1628	9	14
5310-00-167-0833	2	2	5930-00-683-1629	9	14
5310-00-167-0833	9	113	5930-00-683-1633	9	72
5310-00-167-0834	2	12	5940-00-688-9151	15	3
5905-00-171-1999	12	6	5905-00-689-5059	14	7
5905-00-171-2001	10	29	5365-00-698-3422	3	20
5905-00-171-2003	10	32	5310-00-713-0528	9	135
5905-00-171-2004	10	35	5905-00-763-6502	14	9
5325-00-174-9038	4	4	6610-00-769-6826	9	32
5905-00-185-8510	10	21	5975-00-784-4591	3	21
5905-00-185-8510	11	7	5975-00-784-4591	9	124
5905-00-190-8874	12	5	6210-00-806-8845	9	8
5905-00-190-8880	11	13	6210-00-808-8604	9	17
5905-00-190-8881	10	15	5930-00-815-9112	9	13
5905-00-192-3971	12	10	5935-00-820-5854	8	2
5905-00-192-4490	11	8	5975-00-825-3330	9	115
			5970-00-842-1235	15	2
			5935-00-843-7362	6	2
			5310-00-843-7635	3	19
			6240-00-892-4420	9	16
			5935-00-899-6869	7	1
			5910-00-903-4847	10	5
5930-00-226-0564	9	57	5910-00-903-4849	10	4
5940-00-232-5209	15	1	5910-00-903-4850	10	5
4730-00-240-5905	9	105	5910-00-903-4851	10	5
5905-00-249-3661	10	38	5910-00-903-4852	10	5
			5910-00-903-4853	10	5
			5910-00-903-4854	10	5
			5910-00-903-9538	10	5
			5310-00-905-8451	9	60
			5310-00-905-8451	10	47
5940-00-258-2112	15	4	5310-00-905-8451	11	15
5905-00-279-1749	10	31	5310-00-905-8451	12	14
5905-00-279-1750	11	8	5310-00-905-8451	13	10
5905-00-279-1751	14	11	5310-00-905-8451	14	16
5905-00-279-1758	11	8	5995-00-906-6403	1	4
5905-00-279-1760	11	8	6625-00-908-9102	9	5
5905-00-279-1872	14	2	6625-00-908-9103	9	9
5905-00-279-1876	10	20	6625-00-908-9104	9	18
5905-00-279-1877	10	39	6625-00-908-9105	9	71
5905-00-279-1880	10	27	6625-00-908-9107	9	131
5905-00-279-1880	11	10	6685-00-908-9771	9	25
5905-00-279-1880	12	9	5935-00-908-9792	12	11
5905-00-279-1885	11	8	5935-00-908-9796	9	62
5905-00-279-1887	11	8	5935-00-908-9797	9	63
5905-00-279-1894	11	8	5935-00-908-9798	9	61
5905-00-279-1897	11	8	5935-00-908-9799	9	143
5905-00-279-2019	10	26	5995-00-909-1913	1	5
5905-00-279-2019	10	34	5995-00-909-1915	1	3
5905-00-279-2517	13	2	5905-00-910-0770	9	38
5905-00-279-2616	10	28	5930-00-913-3641	3	4
5905-00-279-2673	10	34	4710-00-914-4115	9	86
5905-00-279-3499	10	30	4710-00-914-4117	9	88
5905-00-279-3502	13	3	4710-00-914-4119	9	89
5905-00-279-3503	10	34	4710-00-914-4121	9	87
5905-00-279-3504	10	24	4710-00-914-4123	9	104

SECTION IV

TM 11-6625-646-24P

STOCK NUMBER		NATIONAL STOCK NUMBER AND PART NUMBER INDEX			
	FIG.	ITEM	STOCK NUMBER	FIG.	ITEM
6625-00-918-1850	2	5	4320-00-937-6435	16	12
6625-00-918-1852	9	54	6105-00-937-6467	9	98
6625-00-918-1857	9	64	5935-00-954-6431	11	18
6625-00-918-1861	9	69	5940-00-956-4751	10	46
6625-00-918-9476	9	83	5940-00-956-4751	11	21
5935-00-927-2924	9	144	5940-00-956-4751	13	8
5905-00-928-8159	5	5	5940-00-956-4751	14	15
6625-00-937-4233	16	10	5925-00-967-8685	9	19
3120-00-937-4234	16	4	5905-00-972-3559	5	4
6625-00-937-4235	16	5	5905-00-988-2280	14	8
6625-00-937-4236	9	92	5905-00-988-2307	12	8
6625-00-937-4237	9	111	5905-00-988-2309	14	6
6625-00-937-4238	9	110	5905-00-988-2312	9	59
5340-00-937-5816	16	2	5905-00-988-2319	11	11
4320-00-937-6431	16	9	5935-00-988-4231	4	6
4320-00-937-6432	16	8	5935-00-988-4349	4	1
4320-00-937-6433	16	3	5935-00-990-2737	6	4
4320-00-937-6434	16	13	5305-00-993-0190	9	132

PART NUMBER	FSCM	FIG. NO.	ITEM NO.	PART NUMBER	FSCM	FIG. NO.	ITEM NO.
AB416A	24123	16	1	AN960-6L	88044	11	16
AD407A	24123	16	10	AN960-716L	88044	9	30
AD439	24123	16	4	AN960-8L	88044	2	2
AD441A	24123	16	6	AN960-8L	88044	9	113
AD0444	24123	16	9	AN960C10L	88044	9	65
AD447	24123	16	8	AN960C4L	88044	9	31
AD448	24123	16	7	AN960C6L	88044	10	48
AD449	24123	16	3	AN960C6L	88044	12	113
AD455	24123	16	13	AN960C6L	88044	13	11
AD480	24123	16	2	AN960C6L	88044	14	17
AD484C	24123	16	5	AN960D6	88044	3	10
AD0503	24123	16	12	AN9604L	88044	9	47
AN340C6	88044	16	17	A02VS301-1	77272	9	25
AN505-6R5	88044	9	153	A02VS301-2	77272	9	32
AN505-6R8	88044	9	24	A02VS302-	77272	9	5
AN515-4R5	88044	9	132	A02VS302-2	77272	9	9
AN515-546	88044	4	7	A02VS302-3	77272	9	18
AN515-4R8	88044	9	117	A02VS302-8	77272	9	71
AN515-6R10	88044	3	13	A02V5309-1	77272	1	5
AN515-6R10	88044	9	123	A02VS309-2	77272	1	4
AN515-6R16	88044	9	120	A02VS309-3	77272	1	3
AN515-6R20	88044	3	14	A02VS3101	77272	2	5
AN515-6R6	88044	3	24	A02V3040-3	77272	9	52
AN515-6R6	88044	9	152	A02V3041-10	77272	9	44
AN515-6R8	88044	9	20	A02V3041-11	77272	9	50
AN515-6R8	88044	11	17	A02V3041-12	77272	9	22
AN515-626	88044	3	7	A02V3041-13	77272	9	23
AN515-8R6	88044	2	4	A02V3041-14	77272	9	45
AN515-8R7	88044	9	112	A02V3041-2	77272	9	43
AN515C4R8	88044	9	21	A02V3041-3	77272	9	49
AN515C6R32	88044	16	11	A02V3041-4	77272	9	48
AN515C6R8	88044	12	12	A02V3041-5	77272	9	51
AN515C6R8	88044	13	12	A02V3041-6	77272	9	42
AN515C6R8	88044	14	18	A02V3042-1	77272	9	131
AN51508R6	88044	2	6	A02V3042-2	77272	9	136
AN520-10R14	88044	2	11	A02V3042-4	77272	9	133
AN520C10R20	88044	9	66	A02V3042-5	77272	9	134
AN520C10R24	88044	9	67	A02V3043-1	77272	9	53
AN565AC4H3	88044	3	16	A02V3044-11	77272	9	39
AN565AC4H3	88044	9	11	A02V3044-14	77272	9	82
AN775-4	88044	9	139	A02V3044-15	77272	9	75
AN776-40	88044	9	138	A02V3044-16	77272	9	77
AN816-40	88044	9	105	A02V3044-17	77272	9	83
AN901-4A	88044	9	137	A02V3041-19	77272	9	3
AN924-4D	88044	9	29	A02V3044-20	77272	9	76
AN936A616	88044	9	37	A02V3044-22	77272	9	74
AN960-10L	88044	2	12	A02V3044-24	77272	9	81
AN960-6	88044	3	15	A02V3044-25	77272	2	10
AN960-6L	88044	3	23	A02V3044-26	77272	9	79
AN960-6L	88044	9	84	A02V3044-27	77272	9	69
				A02V3044-28	77272	9	1
				A02V3044-29	77272	9	64
				A02V3044-30	77272	9	54
				A02V3044-31	77272	9	40

SECTION IV

NATIONAL STOCK NUMBER AND PART NUMBER INDEX

TM 11-6625-646-24P

PART NUMBER	FSCM	FIG. NO.	ITEM NO.	PART NUMBER	FSCM	FIG. NO.	ITEM NO.
A02V3044-32	77272	9	4	MS20253-2-350	96906	9	78
				MS20253-2-625	96906	9	2
A02V3045-1	77272	9	126				
A02V3045-10	77272	9	122				
A02V3045-11	77272	9	118				
A02V3045-12	77272	9	119				
A02V3045-2	77272	9	127				
A02V3045-3	77272	9	108				
A02V3045-4	77272	9	107				
A02V3045-5	77272	9	151	MS20365-440	96906	9	85
A02V3045-6	77272	9	130	MS20365-632	96906	9	80
A02V3045-7	77272	9	96	MS21044N04	96906	4	8
A02V3045-8	77272	9	93	MS21044N04	96906	9	36
A02V3045-9	77272	9	109	MS21044N06	96906	3	22
A02V3046-1	77272	9	92	MS24509-3	96906	9	19
A02V3046-2	77272	9	88	MS24523-22	96906	9	14
A02V3046-23	77272	9	104	MS24523-23	96906	9	14
A02V3046-24	77272	9	103	MS24523-27	96906	9	72
A02V3046-26	77272	9	87	MS24524-23	96906	9	73
A02V3046-3	77272	9	111	MS24585C67	96906	9	68
A02V3046-4	77272	9	110	MS24663	96906	6	2
A02V3046-5	77272	9	89	MS250827	96906	9	10
A02V3046-7	77272	9	86	MS25089-3GR	96906	9	13
A02V3046-9	77272	9	91	MS25237-327	96906	9	7
				MS25252NE2D	96906	9	16
				MS25256-2	96906	9	8
A02V3064-2	77272	9	147	MS256-2-327	96906	9	6
A02V3068-1	77272	9	148	MS25257-3	96906	9	15
A02V3074-1	77272	9	57	MS25257-4	96906	9	17
				MS3107A20-4P	96906	7	1
A02V3075-1	77272	9	38	MS3122E20-415	96906	4	6
A02V3132-1	77272	9	97	MS3126E20-41P	96906	4	1
A7990-121-24A	78553	2	1	MS3191-1	96906	17	2
				MS35338-4	96906	16	16
BACC11GY1R0	77272	10	7	MS35338-41	96906	3	9
BACC11GY220	77272	10	3	MS35338-43	96906	16	1
BACC11GY470	56289	10	2	MS35338-44	96906	9	95
BACC11GY470	77272	12	2	MS35338-80	96906	2	3
BACC45HL11	81205	14	19	MS35489-20	96906	4	4
BACC45HL15	77272	12	11				
BACC45HL16	81205	13	13	MS90310-221	96906	3	4
BRACC45HL3	77272	11	18	MS91528-1C4B	96906	3	17
BACC45HM11	77272	9	143	MS91528-1P2B	96906	9	12
BACC45HM15	77272	9	144	NAS1068C06	81349	9	128
BACC45HM16	77272	9	142	NAS43DD1-40	80205	3	20
BACC45HM3	77272	9	62	PT02CE12-3P	77820	9	33
BACC45HM6	77272	9	63				
BACC45HM7	77272	9	61				
BACC47BF1	77272	9	141	PT06A12-3S	77820	6	4
BACC47BGI	77272	9	140	PT06A12-3SY	77820	7	2
BACM10J48WK	77272	3	8	PT06A20-41S	77820	8	2
BACM10LIETF	77272	3	18				
BACM10T16GT	77272	3	1	RC20GF101J	81349	11	8
BACR14CJ393	77272	14	12				
BACT1281	77272	3	11				
				RC20GF103J	81349	10	21
DOTSH	80223	10	44	RC20GF103J	81349	11	7
DOTSH	80223	11	20				
DOT23	80223	10	42	RC20GF122J	81349	11	13
DOT23	80223	13	6	RC20GF123J	81349	13	3
DOT23	80223	14	13	RC20GF125J	8L349	12	5
DOT25	80223	10	40				
DOT25	80223	11	14	RC20GF153J	81349	10	28
DOT25	80223	13	7	RC20GF160J	81349	11	8
DOT36	80223	10	41	RC20GF165J	81349	14	2
DOT39	80223	5	2				
D6-1	00141	9	135	RC20GF182J	81349	10	15
JAN1N645	81349	10	9				
JAN1N645	81349	11	5	RC20GF204J	81349	10	32
JAN1N645	81349	12	4	RC20GF220J	81349	10	36
JAN1N645	81349	13	1	RC20GF220J	81349	11	8
				RC20GF222J	81349	10	20
				RC20GF223J	81349	10	35
				RC20GF240J	81349	11	8
				RC20GF242J	81349	10	39
KTSR179-2	71468	9	129				
K9N10DN	05397	10	8				
MF6001-06	15653	3	19	RC20GF272J	81349	10	27
MS16108-2A	96906	9	26	RC20GF272J	81349	11	10
MS16108-3A	96906	9	27	RC20GF272J	81349	12	9

SECTION IV

TM 11-6625-646-24P

NATIONAL STOCK NUMBER AND PART NUMBER INDEX

PART NUMBER	FSCM	FIG. NO.	ITEM NO.	PART NUMBER	FSCM	FIG. NO.	ITEM NO.
RC20GF273J	81349	10	30	X2043B	71279	13	8
				X20438	71279	14	15
RC20GF302J	81349	14	11	0330P110-202	24123	9	101
RC20GF330J	81349	11	8	1N1823A	81349	9	125
RC20GF331J	81349	12	10	1N3027B	04713	10	10
RC20GF332J	81349	11	9				
RC20GF360J	81349	11	8	10-359470-10	77820	6	1
RC20GF362J	81349	10	29	10-359470-20	77820	8	1
				10-359470-9	77820	6	5'
RC20GF392J	81349	10	33				
RC20GF394J	81349	13	2	10-70506-12	77820	6	3
RC20GF430J	81349	11	8	100-239-0	99378	5	1
				100-239-0	99378	10	43
				100-239-0	99378	11	19
RC20GF472J	81349	10	24	100-239-0	99378	13	9
RC20GF472J	81349	14	10	100-239-0	99378	14	14
				10359470-19	77820	8	5
RC20GF512J	81349	10	26	1042-2	71279	5	3
RC20GF512J	81349	10	34	1059	70485	3	12
RC20GF560J	81349	11	8	109D826X9050T2	56289	12	1
				11-6782	77820	17	3
				11-6900	77820	17	1
RC20GF620J	81349	11	8	114E3029-55	77272	9	116
RC20GF622J	81349	10	34				
RC20GF625J	81349	10	31	114E3049-8	77272	11	18
				114E5987-5	77272	9	99
				114E5987-6	77272	9	56
RC20GF682J	81349	10	34	114E5987-7	77272	1	6
RC20GF683J	81349	10	38	114E5987-9	77272	2	9
RC20GF750J	81349	11	8	114V3058-1	77272	1	2
				114V3059-2	77272	3	2
RC20GF820J	81349	11	8	114V3060-1	77272	3	6
RC20GF821J	81349	12	6	114V3060-2	77272	5	6
RC20GFB22J	81349	10	34	114V3062-1	77272	3	3
RC20GF910J	81349	11	8	120H1FS	94637	1	1
RC20GF910J	81349	13	5	1246-14	71279	5	7
				150D105X9035A2	56289	11	2
				150D154X9035A2	56289	11	3
RN55C1692F	81349	5	5				
RN55C4871F	81349	5	4	151D114X9006W2	56289	10	5
RN60D10R0F	81349	14	6	151D134X9006W2	56289	10	5
RN60D1003F	81349	12	8	151D164X9006W2	56289	10	5
RN60D1502F	81349	11	11	151D194X9006W2	56289	10	5
				151D234X9006W2	56289	10	5
RN60D2001F	81349	14	8	151D235X9006W2	56289	10	4
				151D284X9006W2	56289	10	5
RN60D2800F	81349	14	9	151D344X9006W2	56289	10	5
RN60D5491F	81349	14	7	202	24123	9	98
RN60DS622F	81349	9	59	202A153-3	08795	4	2
				2034-2	71279	5	8
RT11C2P202	81349	10	18	207	24123	16	18
RW69V200	81349	12	7	2164	92194	4	9
SRA2C24B	99928	10	11	29F408	24446	12	3
				29F585	95017	10	6
TY13	59730	9	115	31883	00779	15	4
TY15	59730	3	21	320559	00779	15	1
TY15	59730	9	124	323930	00779	15	3
V71051NSR05N30C3MEC	31356	3	5	325009	00779	15	2
				4527	09922	9	114
WE2-473	99515	11	4	4528	09922	10	45
X2043B	71279	10	46				
X2043B	71279	11	21				

SECTION IV

TM 11-6625-646-24P

NATIONAL STOCK NUMBER AND PART NUMBER INDEX
LATEST NATIONAL STOCK NUMBER ASSIGNMENTS

STOCK NUMBER	FIG.	ITEM	STOCK NUMBER	FIG.	ITEM
5910-00-007-2004	11	1	5935-00-686-3700	8	4
4920-00-019-3787	9	145	5961-00-686-8578	10	13
			5930-00-688-7868	9	41
5950-00-083-0681	5	2	4730-00-715-0018	9	106
5961-00-087-6047	10	9	5950-00-715-4638	10	44
5961-00-087-6047	11	5	5950-00-715-4638	1	20
5961-00-087-6047	12	4	4730-00-722-1207	9	90
5961-00-087-6047	13	1	5821-00-764-5386	9	149
5910-00-104-0144	11	2	5120-00-765-3688	17	1
5905-00-106-9344	10	25	5120-00-765-3689	17	3
5905-00-106-9344	11	8	5950-00-799-4163	10	41
5905-00-113-4856	11	8	5910-00-810-2621	10	7
5905-00-114-5381	11	8	5970-00-812-1356	4	3
5905-00-114-5438	11	8	5910-00-820-9255	11	3
5905-00-141-0600	10	16	5950-00-851-4221	11	14
5905-00-141-1116	10	34	5950-00-851-4221	10	40
			5905-00-851-4221	13	7
5940-00-204-8990	4	5	5120-00-856-3732	17	2
			5961-00-883-5305	10	12
5325-00-290-6163	9	150	5961-00-883-5305	1	6
			5910-00-901-9512	10	1
5935-00-451-5556	9	141	5935-00-903-2445	10	45
5905-00-452-0773	14	4	6625-00-908-9106	10	11
5930-00-476-4563	3	5	5935-00-908-9793	14	19
5935-00-478-3489	9	26	5935-00-908-9794	13	13
5950-00-648-4412	10	42	5910-00-913-4638	11	4
5950-00-648-4412	13	6	5910-00-934-2775	14	1
5950-00-648-4412	14	13	5905-00-935-8540	11	8
5910-00-682-3621	12	3	5950-00-954-3529	9	11
4730-00-684-0087	9	28	5935-00-985-0568	9	35
4730-00-684-0738	2	7	5935-00-988-4231	9	34

LATEST PART NUMBER ASSIGNMENTS

PART NUMBER	FSCM	FIG. NO.	ITEM NO.	PART NUMBER	FSCM	FIG. NO.	ITEM NO.
AN6270-4D0420	88044	2	8	PT02E12-3PY	77820	9	35
A02V3042-3	77272	9	55	PT06A20-41	77820	8	4
A02V3044-8	77272	9	70	RCR20G101JS	81349	10	25
A02V3048-1	77272	9	145	RCR20G101JS	81349	11	8
A02V3060-1	77272	9	146	RCR20G180JS	81349	1	8
A0273074-2	77272	9	41	RCR20G200JS	81349	11	8
CSR13B337KL	81349	10	1	RCR200300JS	81349	11	8
				RCR20G510JS	81349	11	8
				RCR20G562JS	81349	10	34
				RNC60K8250FS	81349	14	4
				TW25F26TS	02640	9	121
				10-607000-15	04939	8	3
				1011-4	00624	2	7
				1012-4	00624	9	28
MS213122E20-41S	96906	9	34	114E3049-19	77272	9	149
MS24393D4	96906	9	106				
MS24402D4	96906	9	90				
MS35489-13	96906	9	150				

SECTION IV

TM 11-6625-646-24P

**NATIONAL STOCK NUMBER AND PART NUMBER INDEX
ADDITIONAL LATEST NATIONAL STOCK NUMBER ASSIGNMENTS**

STOCK NUMBER	FIG.	ITEM	STOCK NUMBER	FIG.	ITEM
5315-00-066-8313	9	78	5905-00-141-0600	10	16
5905-00-104-8336	10	23	5905-00-141-1118	11	8
5905-00-110-0916	10	14	5310-00-067-0838	9	30
5905-00-110-0916	11	12	5905-00-192-3876	14	5
5905-00-110-0916	4	3	5905-00-233-7141	9	58
5905-00-111-4734	10	37	5905-00-240-3015	10	17
5905-00-111-4734	11	8	4720-00-720-0294	2	8
5905-00-111-8357	10	22	5935-00-821-9839	6	3
5905-00-111-8561	11	8	5935-00-887-8898	8	3
5905-00-116-8566	11	8	5305-00-889-2998	9	46
5905-00-116-8568	10	34	5310-00-905-8451	9	94
5905-00-116-8570	10	19	5310-00-934-9765	16	15
			5305-00-984-6195	9	102

ADDITIONAL LATEST PART NUMBER ASSIGNMENTS

PART NUMBER	FSCM	FIG. NO.	ITEM NO.	PART NUMBER	FSCM	FIG. NO.	ITEM NO.
AN62704D042	88044	2	8	RCR20G104JS	81349	10	23
JAN2N338	81349	10	13	RCR20G134JS	81349	13	4
MS21083N06	96906	9	60	RCR20G270JS	81349	11	8
MS21083N06	96906	9	94	RCR20G390JS	81349	11	8
MS21083N06	96906	10	47	RCR20G470JS	81349	10	37
MS21083N06	96906	31	15	RCR20G470JS	81349	11	8
MS21083N06	96906	12	14	RCR20G680JS	81349	11	8
MS21083N06	96906	13	10	RCR20G681JS	81349	13	22
MS21083N06	96906	14	16	RCR20G752JS	81349	10	34
MS25036-111	98410	4	5	RCR20G822JS	81349	10	16
MS23053/5-111-0	81349	4	3	RCR20G912JS	81349	10	19
MS35206-216	96906	9	46	RNR60C1002FS	81349	10	17
MS35206-247	96906	9	12	RN60K150FS	81349	14	5
MS35650-304	96906	16	15	RN60K2741FS	81349	9	58
MS39003-01-0388	81349	11	1	WE1-154D	99515	14	1
RCR20G102JS	81349	10	14	2N652A	81349	10	12
RCR20G102JS	81349	3	12	2N652A	81349	11	6
RCR20G102JS	81349	14	3				

*U.S. GOVERNMENT PRINTING OFFICE: 1993 0 - 342-421 (81196)

By Order of the Secretary of the Army:

Official:

J. C. PENNINGTON
Brigadier General, United States Army
The Adjutant General

BERNARD W. ROGERS
General, United States Army
Chief of Staff

Distribution:

To be distributed in accordance with DA Form 12-31, Direct and General Support maintenance requirements for CH-47A, CH-47B/C aircraft.

RECOMMENDED CHANGES TO EQUIPMENT TECHNICAL PUBLICATIONS



SOMETHING WRONG WITH THIS PUBLICATION?

FROM: (PRINT YOUR UNIT'S COMPLETE ADDRESS)

DATE SENT

PUBLICATION NUMBER

PUBLICATION DATE

PUBLICATION TITLE

BE EXACT... PIN-POINT WHERE IT IS

PAGE NO.	PARA-GRAPH	FIGURE NO.	TABLE NO.

IN THIS SPACE TELL WHAT IS WRONG AND WHAT SHOULD BE DONE ABOUT IT:

TEAR ALONG PERFORATED LINE

PRINTED NAME, GRADE OR TITLE, AND TELEPHONE NUMBER

SIGN HERE:

DA FORM 2028-2
JUL 79

PREVIOUS EDITIONS ARE OBSOLETE.

P.S.—IF YOUR OUTFIT WANTS TO KNOW ABOUT YOUR RECOMMENDATION MAKE A CARBON COPY OF THIS AND GIVE IT TO YOUR HEADQUARTERS.

PIN: 020975-000